

# NINJA®

## CB150ANZ

### INSTRUCTIONS

## TWISTI™ HIGH-SPEED BLENDER DUO™



# THANK YOU FOR PURCHASING

The Ninja® TWISTI™ High-Speed Blender Duo™



## REGISTER YOUR PURCHASE

 **AU** [ninjakitchen.com.au/apps/product-registration](http://ninjakitchen.com.au/apps/product-registration)

**NZ** [ninjakitchen.co.nz/apps/product-registration](http://ninjakitchen.co.nz/apps/product-registration)

 Scan QR code using mobile device

## RECORD THIS INFORMATION

Model Number: \_\_\_\_\_

Serial Number: \_\_\_\_\_

Date of Purchase: \_\_\_\_\_  
(Keep receipt)

Store of Purchase: \_\_\_\_\_

## TECHNICAL SPECIFICATIONS

Voltage: 220-240V~, 50-60Hz  
Watts: 1100W



**PLEASE READ CAREFULLY AND  
KEEP FOR FUTURE REFERENCE.**

# CONTENTS

<b>Product Registration</b> .....	<b>2</b>
<b>Important Safeguards</b> .....	<b>4</b>
<b>Getting to Know Your Blender</b> .....	<b>6</b>
<b>Parts</b> .....	<b>6</b>
<b>Before First Use</b> .....	<b>6</b>
Getting to know the Power Nutri™ Jug .....	6
<b>Using the Control Panel</b> .....	<b>7</b>
<b>Using the Power Nutri Jug</b> .....	<b>8</b>
<b>Using the Power Nutri Cup</b> .....	<b>10</b>
<b>Care &amp; Maintenance</b> .....	<b>12</b>
Cleaning .....	12
Storing .....	12
Resetting the Motor Thermostat .....	12
<b>Troubleshooting Guide</b> .....	<b>13</b>
<b>Ordering Replacement Parts</b> .....	<b>13</b>
<b>Warranty</b> .....	<b>14</b>

# IMPORTANT SAFETY INSTRUCTIONS

PLEASE READ CAREFULLY BEFORE USE • FOR HOUSEHOLD USE ONLY

	<b>Read and review instructions for operation and use.</b>
	<b>Indicates the presence of a hazard that can cause personal injury, death or substantial property damage if the warning included with this symbol is ignored.</b>
	<b>For indoor and household use only.</b>
<b>When using electrical appliances, basic safety precautions should always be followed, including the following:</b>	

**⚠WARNING:** Handle the Hybrid Edge™ Blades Assembly with care, as the blades are loose and sharp.

**⚠WARNING:** Remove utensils prior to processing. Failure to remove may cause the Power Nutri Cup to be damaged or to shatter, which may cause personal injury.

**⚠WARNING:** Do not blend hot, effervescent, or carbonated liquids. Doing so may cause excessive pressure buildup, resulting in risk of laceration and/or the user being burned.

**⚠WARNING:** Remove the Hybrid Edge Blades Assembly from the Power Nutri Cup upon completion of blending. Do not store ingredients before or after blending them in the cup with the blade assembly attached. Some foods may contain active ingredients or release gases that will expand if left in a sealed container, resulting in excessive pressure buildup that can pose a risk of injury.

**⚠WARNING:** To reduce the risk of injury, fire, electrical shock, or property damage, basic safety precautions must always be followed, including the following numbered warnings and subsequent instructions. Do not use appliance for other than intended use.

- Carefully observe and follow all warnings and instructions. This unit contains electrical connections and moving parts that potentially present risk to the user.
- ALWAYS** exercise care when handling the Hybrid Edge Blades Assembly. The blades are sharp, handle carefully. **ONLY** grasp the Hybrid Edge Blades Assembly by the outer perimeter of the blade assembly base. Failure to use care when handling the blade assembly will result in a risk of laceration.
- Take your time and exercise care during unpacking and appliance setup. This appliance contains sharp, loose blades that can cause injury if mishandled.
- Take an inventory of all contents to ensure you have all parts needed to properly and safely operate your appliance.
- Blades are loose and sharp. Handle carefully.
- Always disconnect the appliance from the supply if it is left unattended and before assembling, disassembling or cleaning. To unplug, grasp the plug by the body and pull from the socket. **NEVER** unplug by grasping and pulling the flexible cord.
- Before use, wash all parts that may come into contact with food. Follow washing instructions covered in this instruction manual.
- To protect against the risk of electric shock, **DO NOT** submerge the appliance or allow the power cord to contact any form of liquid.
- DO NOT** use this appliance outdoors. It is designed for indoor household use only.
- DO NOT** operate any appliance with a damaged cord or plug, or after the appliance malfunctions or is dropped or damaged in any manner. This appliance has no user-serviceable parts. If damaged, contact SharkNinja for servicing.
- Extension cords should **NOT** be used with this appliance.
- This appliance should not be used by children. Keep the appliance and its cord out of reach of children. Children should not play with the appliance.
- This appliance is **NOT** intended to be used by people with reduced physical, sensory, or mental capabilities, or lack of experience and knowledge, unless they have been given supervision or instruction concerning use of the appliance by a person responsible for their safety.
- Before each use, inspect blade assembly for damage. If a blade is bent or damage is suspected, contact SharkNinja to arrange for replacement.
- DO NOT** attempt to sharpen blades.

- DO NOT** allow the unit or the cord to hang over the edges of tables or worktops. The cord may become snagged and pull the appliance off the work surface.
- DO NOT** allow any part of the unit to contact hot surfaces, including stoves and other heating appliances.
- ALWAYS** use the appliance on a dry and level surface.
- NEVER** place a blade assembly on the motor base without it first being attached to the container.
- Keep hands, hair and clothing out of the container when loading and operating
- ONLY** use attachments and accessories that are provided with the product or are recommended by SharkNinja. The use of attachments not recommended or sold by SharkNinja may cause fire, electric shock, or injury.
- During operation and handling of the appliance, avoid contact with moving parts.
- DO NOT** operate the appliance with an empty container.
- DO NOT** fill containers past the **MAX FILL** or **MAX LIQUID** lines.
- DO NOT** microwave any containers or accessories provided with the appliance.
- DO NOT** use for grinding ingredients.
- Before operation, ensure all utensils are removed from containers. Failure to remove utensils can cause containers to shatter and potentially result in personal injury and property damage.
- NEVER** operate the appliance without lids and caps in place. **DO NOT** attempt to defeat the interlock mechanism. Ensure the container and lid are properly installed before operation.
- DO NOT** expose the containers and accessories to extreme temperature changes. They may experience damage.
- NEVER** leave the appliance unattended while in use.
- DO NOT** blend hot liquids. Doing so may result in pressure buildup and steam exposure that can pose a risk of the user being burned.
- If you find unmixed ingredients sticking to the sides of the cup, stop the appliance, remove the blade assembly and use a scraper to dislodge ingredients.
- DO NOT** attempt to remove the container and lids from the motor base while the blade assembly is still spinning. Allow the appliance to come to a complete stop before removing lid and container.
- Remove the Hybrid Edge Blades Assembly from the Power Nutri Cup upon completion of blending. **DO NOT** store ingredients before or after blending them in the cup with the blade assembly attached. Some foods may contain active ingredients or release gases that will expand if left in a sealed container, resulting in excessive pressure buildup that can pose a risk of injury. For ingredient storage in the cup, use only Spout Lid to cover.
- If the appliance overheats, a thermal switch will activate and temporarily disable the motor. To reset, unplug the appliance and allow it to cool for approximately 15 minutes before using again.
- The maximum wattage rating for this appliance is based on the configuration of the Hybrid Edge Blades Assembly and Power Nutri Cup. Other configurations may draw less power or current.
- DO NOT** process dry ingredients without adding liquid to the Power Nutri Cup or Power Nutri Jug. They are not intended for dry blending.
- To protect against risk of electrical shock, **DO NOT** immerse the motor base in water or other liquid. Unplug the motor base before cleaning.
- DO NOT** misuse the appliance to avoid potential injury.
- Keep drizzle hole covered while processing.
- Only add liquids through the drizzle hole and do not fill past max fill lines.

## SAVE THESE INSTRUCTIONS

## GETTING TO KNOW YOUR BLENDER

There are a variety of accessories that are compatible with this blender series.

**NOTE:** The top flap of your box shows the select accessories that are included with your model.

To order additional parts and attachments, visit [ninjakitchen.com.au](http://ninjakitchen.com.au) or [ninjakitchen.co.nz](http://ninjakitchen.co.nz)

### PARTS

- A** 1L Power Nutri™ Jug
- B** Jug Lid with Power Paddle
- C** 1 x Spout Lid
- D** 1 x 700ml Power Nutri Cup
- E** Hybrid Edge™ Blade Assembly
- F** Motor Base (attached power cord not shown)

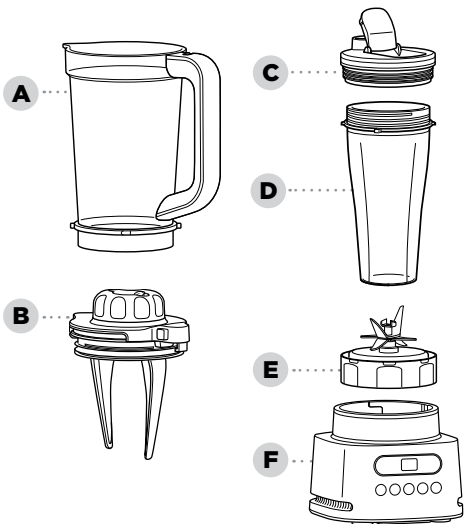

**NOTE:** The Hybrid Edge Blades Assembly is not compatible with other Ninja products.

### BEFORE FIRST USE

**IMPORTANT:** Review all warnings on pages 4-5 before proceeding.

**NOTE:** Handle the Hybrid Edge Blades Assembly by grasping around the perimeter of the blade assembly base.

**NOTE:** Accessories are top-rack dishwasher safe and should **NOT** be cleaned with a heated dry cycle. Ensure blade assembly and lid are removed from the container before placing in the dishwasher. Exercise care when handling blade assembly.

- 1** Remove and discard any packaging material and tape from the unit. Some stickers are to be permanently kept on the unit, **ONLY** remove stickers with 'peel here'. Exercise care when unpacking blade assembly, as the blades are sharp.
- 2** Wash containers, lids and blade assembly in warm, soapy water using a dishwashing utensil with a handle to avoid direct contact with the blades. Exercise care when handling blade assembly, as the blades are sharp.
- 3** Thoroughly rinse and air-dry all parts.

### GETTING TO KNOW THE POWER NUTRI JUG



Powering through tough and frozen ingredients used to require a lot of stopping, scraping and recipe tinkering. But now, it's easier than ever to create thick and spoonable smoothie bowls, nut butters and more. All you have to do is twist the Power Paddle while blending to push ingredients down toward the blade. It's like having a built-in tamper.

## USING THE CONTROL PANEL

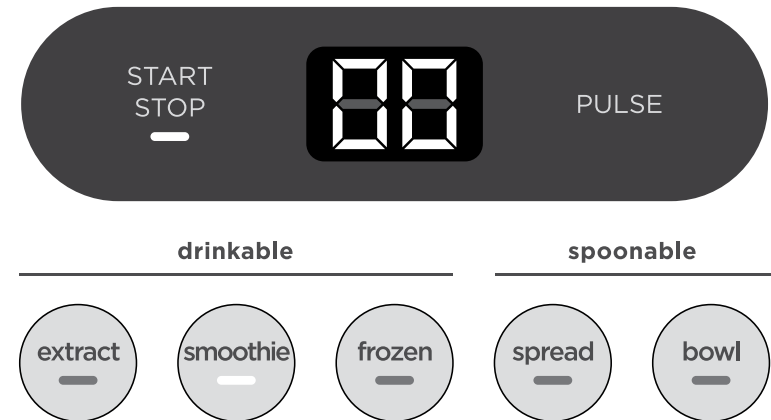

### AUTO-IQ® PROGRAMS

Intelligent preset programs combine unique blending and pausing patterns that do the work for you. Once a preset program is selected, it will start immediately and automatically stop when blending is complete. To stop blending before the end of the program, press the currently active button again.

#### EXTRACT

Ideal for tough, leafy, or fibrous whole fruits and vegetables, including their skins, seeds, and stems.

#### SMOOTHIE

Combine your favorite fresh or frozen ingredients, liquids, and powders to create smoothies and protein shakes.

#### FROZEN

Crush ice and frozen fruit into restaurant-style frozen drinks.

#### SPREAD

Create anything from spreadable nut butters to zesty dressings to the perfect hummus.

#### BOWL

Make thick, spoonable smoothie bowls, creamy frozen yoghurt, and refreshing sorbets.

### MANUAL MODE

#### PULSE

Offers greater control of pulsing and blending. Operates only when PULSE is pressed. Use short presses for short pulses and long presses for long pulses.

#### START/STOP

Press for continuous blending up to 60 seconds; press again to stop. Can also be pressed to stop a running Auto-iQ program.

**NOTE:** For best results when making thicker recipes, use the MIX or POWERMIX program and twist the Power Paddle in the jug while processing.

# USING THE POWER NUTRI JUG

**IMPORTANT:** Review all warnings on pages 4-5 before proceeding.

**NOTE:** If the unit is plugged in but the jug or cup and blade assembly is not properly installed, the timer will display "--" and the motor will be disabled.

**NOTE:** Auto-iQ programs have pauses and changes in speed throughout the cycle.

- 1 Plug in motor base and place on a clean, dry, level surface such as a worktop or table.
- 2 Screw on the blade assembly until you have a tight seal and add liquid then ingredients to the Power Nutri Jug. **DO NOT** add liquid past the **LIQUID FILL** line or ingredients past the **MAX FILL** line.

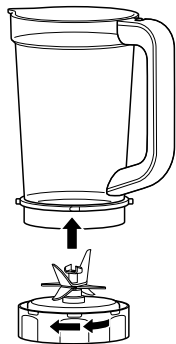

- 3 Install the lid by aligning the red tab to the right of the jug handle. Rotate the tab clockwise into the jug handle to align and lock into place.

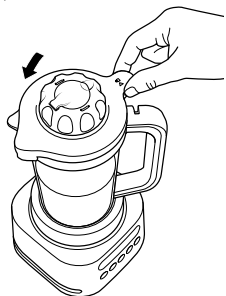

- 4 Install the jug onto the base. Rotate jug clockwise until it clicks into place. Programs will illuminate when unit is ready to use.

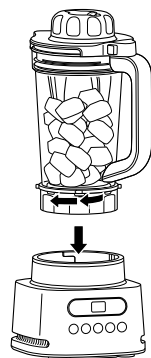

**NOTE:** Keep the drizzle cap closed when processing liquids.

**NOTE:** While processing, twist the Power Paddle *anti-clockwise* continuously.

- 5a If using an Auto-iQ program, select the program that best suits your desired output. During the blending process, twist the Power Paddle **anti-clockwise** continuously. The preset feature will automatically stop at the end of the program. To stop the unit at any time, press the currently active program again.

- 5b If using START/STOP, once the ingredients have reached your desired consistency, press START/STOP again and wait for the unit to come to a complete stop. During the blending process, make sure to twist the Power Paddle **anti-clockwise** continuously.

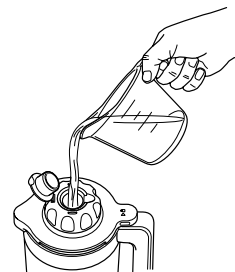

**NOTE:** If results are too thick, open the drizzle hole cap and add more liquid. Close the cap and continue twisting the tamper anti-clockwise during blending.

- 6 Remove the jug from the motor base by turning it anti-clockwise and then lifting up.

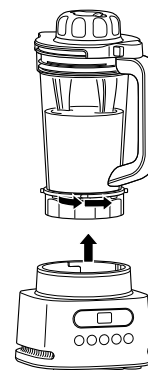

- 7 When blending is complete, remove the jug from the base. Remove lid and empty contents. When jug is empty, remove blade assembly. **DO NOT** store blended contents with the blade assembly attached. Exercise care when handling the blade assembly, as the blades are sharp.

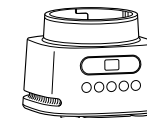
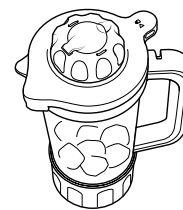

- 8 Unplug the unit when finished. Refer to the Care & Maintenance section for cleaning and storage instructions.

**NOTE:** If the motor base is difficult to remove from the worktop or table, slide it across the surface, then lift. It shouldn't be forced as the suction cups will grip more tightly to the surface.

# USING THE POWER NUTRI CUP

**IMPORTANT:** Review all warnings on pages 4-5 before proceeding.

**NOTE:** If the unit is plugged in, but the jug or cup and blade assembly is not properly installed, the timer will display - -" and the motor will be disabled.

**NOTE:** Auto-iQ programs have pauses and changes in speed throughout the cycle.

**NOTE:** The Power Nutri Cup and Jug share the Hybrid Edge Blade Assembly. Unscrew from pre-assembled Jug.

**⚠WARNING:** Handle the Hybrid Edge Blades Assembly with care, as the blades are loose and sharp.

**⚠WARNING:** Remove utensils prior to processing. Failure to remove may cause the Power Nutri Cup to be damaged or to shatter, which may cause personal injury.

**⚠WARNING:** Do not blend hot, effervescent, or carbonated liquids. Doing so may cause excessive pressure buildup, resulting in risk of laceration and/or the user being burned.

**⚠WARNING:** Remove the Hybrid Edge Blades Assembly from the Power Nutri Cup upon completion of blending. Do not store ingredients before or after blending them in the cup with the blade assembly attached. Some foods may contain active ingredients or release gases that will expand if left in a sealed container, resulting in excessive pressure buildup that can pose a risk of injury.

- 1** Plug in motor base and place on a clean, dry, level surface such as a worktop or table.



- 2** Add ingredients to the Power Nutri Cup. **DO NOT** add ingredients past the **MAX LIQUID** line.



- 3** Place the Hybrid Edge Blades Assembly on the top of the cup and turn clockwise to seal.

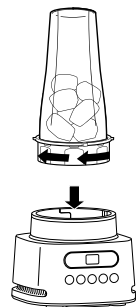

- 4** Turn the cup upside down and install on the motor base by aligning the tabs on the cup with the slots on the base. Then, rotate cup clockwise until it clicks. Once locked in place, the available program buttons will illuminate and the unit will be ready for use.

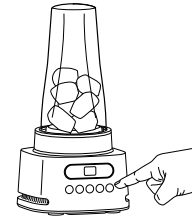

- 5a** If using an Auto-iQ program, select the program that best suits your desired output. The preset feature will automatically stop at the end of the program. To stop the unit at any time, press the currently active program again.
- 5b** If using START/STOP, once the ingredients have reached your desired consistency, press START/STOP again and wait for the unit to come to a complete stop.

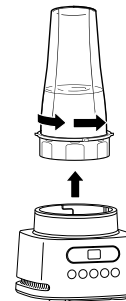

- 6** Remove the cup from the motor base by turning it anti-clockwise and then lifting up.



- 7** Remove the blade assembly by twisting anti-clockwise. **DO NOT** store blended contents with the blade assembly attached. Only use the Spout Lid to cover. Exercise care when handling the blade assembly, as the blades are sharp.



- 8** To enjoy on the go, place the Spout Lid onto the cup and twist lid clockwise until firmly sealed.

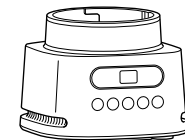

- 9** Unplug the unit when finished. Refer to the Care & Maintenance section for cleaning and storage instructions.

**NOTE:** If the motor base is difficult to remove from the worktop or table, slide it across the surface, then lift. It shouldn't be forced as the suction cups will grip more tightly to the surface.

## CARE & MAINTENANCE

### CLEANING

#### Hand-Washing

Wash containers, lids and blade assembly in warm, soapy water. Use a dishwashing utensil with handle to avoid direct contact with the blades. Exercise care when handling the blade assembly as the blades are sharp. Thoroughly rinse and air-dry all parts.

**NOTE:** The Power Paddle in the Power Nutri Jug is not removable.

#### STUCK-ON INGREDIENTS IN THE POWER NUTRI JUG & CUP

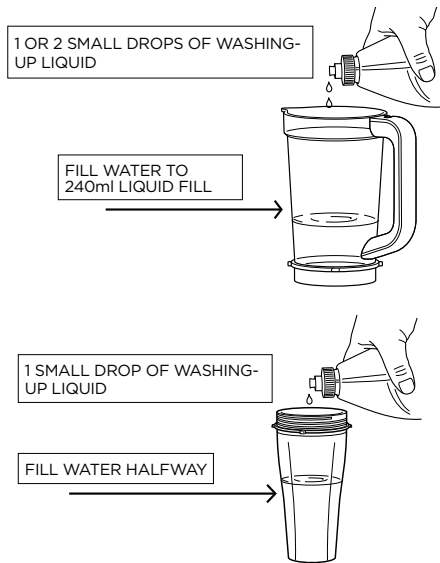

For stuck-on ingredients, such as nut butter, rinse the jug and blade assembly under warm water.

Next, fill the jug or cup with warm water up to liquid fill or halfway on the cup and add 1-2 small drops of washing-up liquid.

Screw on the blade assembly and press MIX. Twist the Power Paddle anti-clockwise continuously while cleaning.

Then, empty contents and rinse under warm water and wipe with a dishwashing utensil, if needed.

#### Dishwasher

Accessories are top-rack dishwasher safe and should **NOT** be cleaned with a heated dry cycle. Ensure the blade assembly and lid are removed from the container before placing in the dishwasher.

**NOTE:** For best results, use a dishwasher to remove stuck-on ingredients.

#### Motor Base

Unplug the unit before cleaning. Wipe motor base with a clean, damp cloth. **DO NOT** use abrasive cloths, pads or brushes to clean the base.

#### STORAGE

For cord storage, wrap cord with hook-and-loop fastener near the back of the motor base. **DO NOT** wrap the cord around the bottom of the base for storage.

**DO NOT** store blended or unblended ingredients in the cup or jug with the blade assembly attached. Use only the spout lid when storing blended or unblended ingredients in the containers.

**DO NOT** stack items on top of the containers. Store any remaining attachments alongside the unit or in a cabinet where they will not be damaged or create a hazard.

#### RESETTING THE MOTOR THERMOSTAT

This unit features a safety system that prevents damage to the motor and drive system should you inadvertently overload it. If the unit is overloaded, the motor will be temporarily disabled. Should this occur, follow the reset procedure below.

- 1 Unplug the unit from the electrical socket.
- 2 Allow the unit to cool for approximately 15 minutes.
- 3 Remove the blade assembly from the container. Empty the container and ensure no ingredients are jamming the blade assembly.

**IMPORTANT:** Ensure that maximum capacities are not exceeded. This is the most typical cause of appliance overload.

## TROUBLESHOOTING GUIDE

**⚠WARNING:** To reduce the risk of shock and unintended operation, turn power off and unplug unit before troubleshooting.

#### Display reads “- -”.

- If vessel is properly installed and the display reads ‘- -’, ensure the interior of the base area is clean of any debris.

#### Control panel does not illuminate.

- Make sure unit is plugged in. If the unit is powered on and no container is installed, the unit will display ‘- -’. The available programs will illuminate after placing a container on base and rotating it clockwise until it clicks into place.

#### Control panel doesn't turn off.

- Remove container from base by rotating it anti-clockwise and lifting it up. The display will flash ‘- -’. Unplug the power cord from the socket. If the unit remains plugged in, the display will time out after 3 minutes of inactivity. Press any button to wake the unit.

#### Doesn't mix well; ingredients get stuck.

- Using the Auto-iQ programs is the easiest way to achieve great results. The pulses and pauses allow the ingredients to settle toward the blade assembly. If ingredients are routinely getting stuck, adding some liquid will usually help.
- When filling the cup, start with fresh fruit or vegetables, then leafy greens or herbs. Next add liquids or yoghurt, then seeds, powders or nut butters. Finally, add ice or frozen ingredients.
- If using the Power Nutri Jug, during the blending process twist the Power Paddle anti-clockwise continuously to circulate ingredients.

#### Unit moves on worktop while blending.

- Ensure the suction cup feet are clean and dry. Place the motor base on a smooth, clean and level surface. Do not place motor base on a rough or unlevel surface as the suction cup feet will not adhere properly.

#### Unit is difficult to remove from worktop for storage.

- If the motor base is difficult to remove from the worktop or table, slide it across the surface, then lift. Tilt the motor base to disengage the suction feet.

#### Lid or Hybrid Edge Blades Assembly is hard to install on the container.

- Set the container on a level surface. Carefully place the lid or blade assembly on the top of the container and align the threads so the lid/blade assembly sits flat. Twist clockwise until you have a tight seal.

#### Can't remove the Power Paddle from the Power Nutri Jug Lid.

- The Power Paddle in the Power Nutri Jug Lid is not removable. For cleaning instructions, refer to the Cleaning section.

## ORDERING REPLACEMENT PARTS

To order additional parts and attachments, visit [ninjakitchen.com.au](http://ninjakitchen.com.au) | [ninjakitchen.co.nz](http://ninjakitchen.co.nz)

**ONE (1) YEAR LIMITED WARRANTY**

For warranty claims, you will need to submit a proof of purchase in the form of a valid receipt that displays date and place of purchase. This warranty does not replace but is in addition to your statutory rights.

If your product becomes defective due to faulty material or workmanship within a period of one (1) year from the date of purchase, we warrant to do the following:

- **For New Zealand Consumers:** We will replace the defective/faulty part with a new product, free of charge, or if the unit is deemed defective/faulty we replace the unit with an equivalent or upgraded model, at our discretion.
- **For Australian Consumers:** Our goods come with guarantees that cannot be excluded under the Australian Consumer Law. You are entitled to a replacement or refund for a major failure and for compensation for any other reasonably foreseeable loss or damage. You are also entitled to have the goods repaired or replaced if the goods fail to be of acceptable quality and the failure does not amount to a major failure.

Replacement items will be covered by the limited warranty for the balance of the warranty period from the date of the original purchase.

**Your warranty is subject to the following conditions**

- DO NOT operate the appliance with a damaged plug or cord, or if the unit has been dropped, damaged or dropped in water.
- To avoid the risk of electric shock, do not disassemble or attempt to repair the appliance on your own. If the supply cord is damaged, it must be replaced by a qualified electrician to avoid a hazard. Incorrect re-assembly or repair can cause a risk of electric shock or injury to persons when the appliance is used.
- The item has not been misused, abused, neglected, altered, modified or repaired by anyone.
- The item has been subjected to fair wear and tear.
- The item has not been used for trade, professional or hire purposes.
- The item has not sustained damage through foreign objects, substances or accident

**Customer costs within warranty**

The customer is responsible for any inwards freight charge to return a product for warranty if requested, and outward freight charge for warranty parts and or replacement unit.

**Who is covered?**

This warranty applies only to the original purchaser, who bought the product from an authorised retailer and may not be transferred. Proof of purchase is required.

**What is not covered?**

- Accessories supplied with the item.
- Components that are subject to natural wear and tear caused by normal use in accordance with operating instructions.
- Unauthorised/improper maintenance/handling or overload is excluded from this warranty.

---

---

---

---

---

---

---

---

---

---

---

---

---

---

---

---

---

---

---

---

---

---

---







VISIT US ONLINE AT:

**AU** [ninjakitchen.com.au](http://ninjakitchen.com.au) **NZ** [ninjakitchen.co.nz](http://ninjakitchen.co.nz)

Or follow us on our social media pages:

  @ninjakitchenau | @ninjakitchennz

**Proudly distributed by**  
**Mann & Noble Pty Ltd**  
**Building D, 33 Quarry Road**  
**Erskine Park NSW, Australia, 2759**  
**AU 02 8801 7666 | NZ 0800 112 660**  
**[AU ninjakitchen.com.au](http://ninjakitchen.com.au) | [NZ ninjakitchen.co.nz](http://ninjakitchen.co.nz)**

Illustrations may differ from actual product. We are constantly striving to improve our products, therefore the specifications contained herein are subject to change without notice.

AUTO-IQ and NINJA are registered trademarks of SharkNinja Operating LLC.

BLENDER DUO, HYBRID EDGE, POWER NUTRI, and TWISTI are trademarks of SharkNinja Operating LLC.

© 2023 SharkNinja Operating LLC

CB150ANZ\_IB\_MP\_Mv6

