

NINJA®

CB402ANZ

OWNER'S GUIDE

FOODI® POWER BLENDER ULTIMATE SYSTEM

with XL Power Smoothie Bowl, Power Nutri™ Cup*,
and Coffee & Spice Grinder



*Extract a drink containing vitamins
and nutrients from fruits and vegetables.



AU ninjakitchen.com.au
NZ ninjakitchen.co.nz

THANK YOU

for purchasing the Ninja® Foodi® Power Blender Ultimate System

REGISTER YOUR PURCHASE

 AU ninjakitchen.com.au

NZ ninjakitchen.co.nz

RECORD THIS INFORMATION

Model Number: _____

Serial Number: _____

Date of Purchase: _____
(Keep receipt)

Store of Purchase: _____

TECHNICAL SPECIFICATIONS

Voltage: 220-240V~, 50-60Hz

Power: 1200 Watts

**PLEASE READ CAREFULLY AND
KEEP FOR FUTURE REFERENCE.**



CONTENTS

Important Safety Instructions	4
Parts	8
Before First Use	9
Getting to Know the Disc Assemblies	9
Using the 2-Part Pusher	9
Using the Control Panel	10
Using Variable Speed Control	10
Using the Auto-iQ® Programs	11
Using the Power Blender & Processor Pitcher & Disc Assemblies	12
Using the Power Blender & Processor Pitcher with Flat Lid & Stacked Blade Assembly	14
Using the Power Blender & Processor Pitcher with Flat Lid & Dough Blade Assembly	16
Using the XL Smoothie Bowl Maker	18
Using the Power Nutri™ Cup*	20
Using the Ninja Coffee & Spice Grinder	22
Grinder Charts	23
Care & Maintenance	24
Using the Blender For Stuck-On Ingredients.....	24
Cleaning.....	25
Storing.....	25
Resetting the Motor.....	25
Ordering Replacement Parts.....	25
Troubleshooting Guide	26
Warranty	27

*Extract a drink containing vitamins and nutrients from fruits and vegetables.

IMPORTANT SAFETY INSTRUCTIONS

PLEASE READ CAREFULLY BEFORE USE • FOR HOUSEHOLD USE ONLY

	Read and review instructions for operation and use.
	Indicates the presence of a hazard that can cause personal injury, death or substantial property damage if the warning included with this symbol is ignored.
	For indoor and household use only.
When using electrical appliances, basic safety precautions should always be followed, including the following:	

⚠ WARNING

- 1 Read all instructions prior to using the appliance and its accessories.
- 2 Carefully observe and follow all warnings and instructions. This unit contains electrical connections and moving parts that potentially present risk to the user.
- 3 Take your time and exercise care during unpacking and appliance setup. This appliance contains sharp, loose blades that can cause injury if mishandled.
- 4 Take inventory of all contents to ensure you have all parts needed to properly and safely operate your appliance.
- 5 Blades are sharp. Care shall be taken when handling the sharp cutting blades, emptying the bowl and during cleaning.
- 6 This product is provided with a Stacked Blade Assembly. **ALWAYS** exercise care when handling blade assemblies. The blade assemblies are sharp and are **NOT** locked in place in their containers. The blade assemblies are designed to be removable to facilitate cleaning and replacement if needed. **ONLY** grasp the blade assembly by the top of the shaft. Failure to use care when handling the blade assemblies will result in a risk of laceration.
- 7 **ALWAYS** exercise care when handling the Hybrid Edge™ Blades Assembly. The blades are sharp. **ONLY** grasp the Hybrid Edge Blades Assembly by the outer perimeter of the blade assembly base. Failure to use care when handling the blade assembly will result in a risk of laceration.
- 8 Turn the appliance **OFF**, then unplug the appliance from the outlet when not in use, before assembling or disassembling parts, and before cleaning. To unplug, grasp the plug by the body and pull from the outlet. **NEVER** unplug by grasping and pulling the flexible cord.
- 9 Before use, wash all parts that may contact food. Follow washing instructions covered in this instruction manual.
- 10 Before each use, inspect blade assemblies for damage. If a blade is bent or damage is suspected, contact SharkNinja to arrange for replacement.
- 11 **DO NOT** use this appliance outdoors. It is designed for indoor household use only.
- 12 **DO NOT** operate any appliance with a damaged cord or plug, or after the appliance malfunctions or is dropped or damaged in any manner. This appliance has no user-serviceable parts. If damaged, contact SharkNinja for servicing.
- 13 This appliance has important markings on the plug blade. The entire supply cord is not suitable for replacement. If damaged, please contact SharkNinja for service.
- 14 Extension cords should **NOT** be used with this appliance.
- 15 To protect against the risk of electric shock, **DO NOT** submerge the appliance or allow the power cord to contact any form of liquid.
- 16 **DO NOT** allow the cord to hang over the edges of tables or counters. The cord may become snagged and pull the appliance off the work surface.
- 17 **DO NOT** allow the unit or the cord to contact hot surfaces, including stoves and other heating appliances.
- 18 **ALWAYS** use the appliance on a dry and level surface.
- 19 Children should be supervised to ensure that they do not play with the appliance.
- 20 This appliance is **NOT** intended for use by persons (including children) with reduced physical, sensory or mental capabilities, or lack of experience and knowledge, unless they have been given supervision or instruction concerning use of the appliance by a person responsible for their safety.
- 21 **ONLY** use attachments and accessories that are provided with the product or are recommended by SharkNinja. The use of attachments, including canning jars, not recommended or sold by SharkNinja may cause fire, electric shock, or injury.
- 22 **NEVER** place a blade assembly on the motor base without it first being attached to its corresponding container (pitcher, cup or bowl) with the lid also in place.
- 23 Keep hands, hair, and clothing out of the container when loading and operating.
- 24 During operation and handling of the appliance, avoid contact with moving parts.
- 25 **DO NOT** fill containers past the **MAX FILL** or **MAX LIQUID** lines.
- 26 **DO NOT** operate the appliance with an empty container.
- 27 **DO NOT** microwave any containers or accessories provided with the appliance.
- 28 **NEVER** leave the appliance unattended while in use.
- 29 **DO NOT** blend hot liquids. Doing so may result in pressure buildup and steam exposure that can pose a risk of the user being burned.
- 30 **DO NOT** process dry ingredients without adding liquid to the single-serve cup, XL bowl, or Pitcher. They are not intended for dry blending.
- 31 **DO NOT** perform grinding operations.
- 32 **NEVER** operate the appliance without lids and caps in place. **DO NOT** attempt to defeat the interlock mechanism. Ensure the container and lid are properly installed before operation.
- 33 Before operation, ensure all utensils are removed from containers. Failure to remove utensils can cause containers to shatter and potentially result in personal injury and property damage.
- 34 **DO NOT** misuse the appliance to avoid potential injury.

SAVE THESE INSTRUCTIONS

IMPORTANT SAFETY INSTRUCTIONS

PLEASE READ CAREFULLY BEFORE USE • FOR HOUSEHOLD USE ONLY

⚠ WARNING

- 35** Keep hands and utensils out of containers while chopping to reduce the risk of severe personal injury or damage to the blender/food chopper. A scraper may be used **ONLY** when the blender or processor is not running.
- 36** If you find unmixed ingredients sticking to the sides of the cup, stop the appliance, remove the blade assembly, and use a scraper to dislodge ingredients.
- 37 DO NOT** open the pitcher's pour spout cap while blender is operating.
- 38** If you find unmixed ingredients sticking to the sides of the pitcher, stop the appliance, remove the lid, and use a spatula to dislodge ingredients. **NEVER** insert your hands into the pitcher, as you may contact one of the blades and experience a laceration.
- 39 DO NOT** attempt to remove the container or lid from the motor base while the blade assembly is still spinning. Allow the appliance to come to a complete stop before removing lids and containers.
- 40** If the appliance overheats, a thermal switch will activate and temporarily disable the motor. To reset, unplug the appliance and allow it to cool for approximately 15 minutes before using again.
- 41 DO NOT** expose the containers and accessories to extreme temperature changes. They may experience damage.
- 42** Upon completion of processing, ensure the blade assembly is removed **BEFORE** emptying container's contents. Remove the blade assembly by carefully grasping the top of the shaft and lifting it from the container. Failure to remove the blade assembly before emptying the container results in a risk of laceration.
- 43** If using the pitcher's pour spout, hold the cover in place on the container or ensure lid lock is engaged when pouring to avoid risk of injury.
- 44** Remove the Hybrid Edge Blades Assembly from the single-serve cup or XL bowl upon completion of blending. **DO NOT** store ingredients before or after blending them in the cup or bowl with the blade assembly attached. Some foods may contain active ingredients or release gases that will expand if left in a sealed container, resulting in excessive pressure buildup that can pose a risk of injury. For ingredient storage in the cup, use only Spout Lid or Storage Lid to cover.
- 45 DO NOT** submerge the motor base or control panel in water or other liquids. **DO NOT** spray motor base or control panel with any liquid.
- 46 DO NOT** attempt to sharpen blades.
- 47** Turn off the appliance and unplug the motor base before cleaning.
- 48** Never feed food by hand. Always use food pusher.
- 49** Unit is intended to create a dough ball. It is **NOT** intended to continuously knead. After dough ball forms, additional kneading should be done by hand on a work surface. If the unit moves excessively on the work surface, remove the dough ball and knead by hand.
- 50** Always use the grinder on a dry, stable work surface away from water.
- 51 DO NOT** allow young children to operate the grinder or use as a toy. Close supervision is necessary when any grinder is used by or near children.
- 52 DO NOT** use the grinder for anything other than its intended use.
- 53 DO NOT** operate the grinder on or near any hot surfaces (such as gas or electric burner, or in a heated oven).

NOTE: When using the pitcher and stacked blade assembly, **DO NOT** process more than 600g of raw meat, 600g of Parmesan (hard) cheese, or 700g of baking chocolate.

- 54 DO NOT** expose the grinder to extreme temperature changes.
- 55 DO NOT** use the grinder if the parts are cracked or chipped.
- 56 DO NOT** use the grinder if blades are bent or damaged.
- 57 DO NOT** attempt to sharpen blades.
- 58 DO NOT** overfill.
- 59 DO NOT** operate the grinder empty.
- 60 DO NOT** operate without the cover in place.
- 61 DO NOT** try to defeat the interlock mechanism.
- 62 DO NOT** use outdoors.

SAVE THESE INSTRUCTIONS

PARTS

- A** Pitcher Flat Lid
- B** 2-Part Pusher
- C** Pitcher Feed Chute Lid
- D** 2.1 L* Power Blender & Processor Pitcher
- E** Motor Base
- F** Total Crushing® & Chopping Blade Assembly (Stacked Blade Assembly)
- G** Dough Blade Assembly
- H** Reversible Slicing/Shredding Disc
- I** Grating Disc (not available with all models)
- J** Disc Spindle
- K** Hybrid Edge™ Blades Assembly
- L** Spout Lid
- M** 700 ml Power Nutri™ Cup**
- N** Storage Lid
- O** 530 ml XL Power Smoothie Bowl with Built-in Tamper
- P** Grinder Lid
- Q** Blade Assembly with Stainless Steel Grinding Cup

*1.9 L max liquid capacity.

NOTE: The Hybrid Edge Blades Assembly is not compatible with other Ninja products.

**Extract a drink containing vitamins and nutrients from fruits and vegetables.

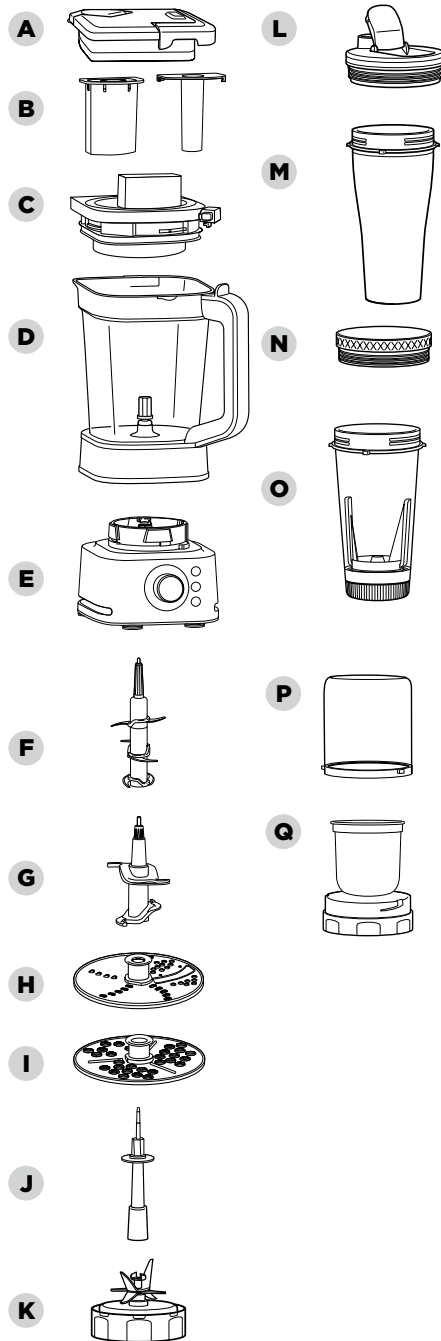

BEFORE FIRST USE

IMPORTANT: Review all warnings on pages 4-7 before proceeding.

To purchase more accessories, visit **AU** ninjakitchen.com.au or **NZ** ninjakitchen.co.nz.

NOTE: All attachments are BPA free and dishwasher safe. Ensure blade assemblies and lids are removed from the containers before placing in the dishwasher. Exercise care when handling blade assemblies.

- 1** Remove all packaging materials from the unit. Exercise care when unpacking blade assemblies, as the blades are sharp.
- 2** The stacked blade assembly is **NOT** locked in place in the container. Handle the stacked blade assembly and dough blade assembly by grasping the top of the shaft.
- 3** Handle the Hybrid Edge Blades Assembly by grasping around the perimeter of the blade assembly base.
- 4** Wash containers, lids, discs, and blade assemblies in warm, soapy, water using a dishwashing utensil with a handle to avoid direct contact with the blades. Exercise care when handling blade assemblies, as the blades are sharp.
- 5** Thoroughly rinse and air-dry all parts.

GETTING TO KNOW THE DISC ASSEMBLIES

NOTE: Install the disc spindle into the pitcher before installing the disc assembly.



**REVERSIBLE SLICING/
SHREDDING DISC**

The reversible slicing/shredding disc is perfect for outputs like thinly sliced cucumbers and shredded carrots. Face the side labeled “slicer” up for slicing and face the side labeled “shredder” up for shredding.

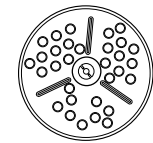

GRATING DISC
(not available with all models)

The grating disc is ideal for outputs like grated Parmesan cheese.

USING THE 2-PART PUSHER



Use the 2-part food pusher to help guide the food through the feed chute. The middle piece of the food pusher is removable to use for narrow ingredients, such as carrots. Rotate the top clockwise and lift to separate the pieces.

USING THE CONTROL PANEL

 Use the Power button to turn the unit on or off.

SWITCHING BETWEEN AUTO-IQ AND MANUAL MODE:

To toggle between Auto-iQ Mode and Manual Mode, press the IQ/MANUAL button.

NOTE: In Manual Mode, Auto-iQ programs will not illuminate on the control panel.

AUTO-IQ MODE

Unique timed programs customized to take the guesswork out of making great drinks and meals.

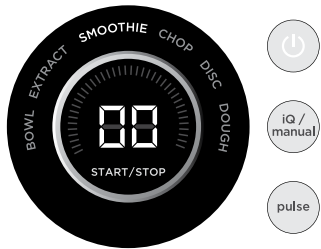

SELECT AND RUN AN AUTO-IQ PROGRAM

Use the dial to select the desired program, then press START/STOP to begin. As the program runs, the timer will count down and the speedometer will show speed. When the countdown ends, blending will stop automatically. To stop blending before the end of the program, press START/STOP again.

USING VARIABLE SPEED CONTROL & THE POWER BLENDER & PROCESSOR PITCHER

NOTE: If using the dough blade assembly, only use the flat lid and speed 1.

START SLOW

Always start at a low speed (1-3) to better incorporate ingredients and prevent them from sticking to the side of the vessel.

DIAL UP THE SPEED

Smoother blends call for higher speeds. Low speeds are great for chopping veggies and mixing dough, but you'll need to ramp up for purees and dressings.

HIGH-SPEED BLENDING

Blend until you get your desired consistency. The longer you blend, the better the breakdown and smoother the outcome will be.

USING THE AUTO-IQ PROGRAMS

NOTE: The unit can detect if the pitcher with the flat lid, pitcher with the feed chute lid or the cup/bowl installed on the motor base. Only the functions available for a particular container will illuminate on the control panel.

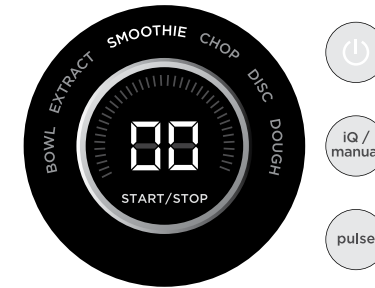

AUTO-IQ PROGRAM FOR THE PITCHER WITH FLAT LID

SPREAD (not available on all models)

Create anything from spreadable nut butters to zesty dressing to the perfect hummus.

SMOOTHIE

Combine your favorite fresh or frozen ingredients, liquids, and powders to create smoothies and protein shakes.

BOWL

Make thick, spoonable smoothie bowls to creamy frozen yogurt to refreshing sorbets.

CHOP

Timed pulses and pauses give you consistent chopping results. Run program once for a large chop, twice for a small chop and three times if you prefer to mince.

DOUGH

Use the Dough Blade Assembly to create dough for pizza, bread, and baked goods. When using the Dough Blade Assembly, only use the DOUGH program or speed 1.

AUTO-IQ PROGRAM FOR THE PITCHER WITH FEED CHUTE LID

DISC

Slice, shred and grate using a variety of fresh ingredients. **When using the disc assemblies, use the feed chute lid and only the DISC program or speed 1.**

AUTO-IQ PROGRAMS FOR THE POWER NUTRI CUP* AND XL POWER SMOOTHIE BOWL

EXTRACT

Ideal for tough, leafy, or fibrous whole fruits and vegetables, including their skins, seeds, and stems.

SMOOTHIE

Combine your favorite fresh or frozen ingredients, liquids, and powders to create smoothies and protein shakes.

NOTE: For best results when using the single-serve cup, use the Auto-iQ Programs EXTRACT & SMOOTHIE.

SPREAD (not available on all models)

Create anything from spreadable nut butters to zesty dressing to the perfect hummus.

BOWL

Make thick, spoonable single-serve smoothie bowls to creamy frozen yogurt to refreshing sorbets.

NOTE: For best results when using the XL bowl, use the Auto-iQ SPREAD & BOWL.

*Extract a drink containing vitamins and nutrients from fruits and vegetables.

USING THE POWER BLENDER & PROCESSOR PITCHER & DISC ASSEMBLIES

IMPORTANT: Review all warnings on pages 4-7 before proceeding.

IMPORTANT: As a safety feature, when the unit is powered on, if the pitcher and lid are not properly installed, the timer will display “-” and the motor will be disabled. If this happens, repeat step 4. When the pitcher and lid are properly installed, and the unit is powered on, the available programs will illuminate, indicating the appliance is ready to use.

NOTE: The slicing/shredding disc is reversible. Use the side labeled “Slicer” for slicing. Carefully flip the disc over to the side labeled “Shredder” for shredding.

NOTE: The feed chute lid features a 2-part pusher to guide food through the chute. Rotate the top counterclockwise and lift to separate the pieces.

- 1 Place motor base on a clean, dry, level surface such as a countertop or table, then plug in the unit.

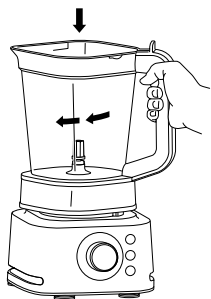

- 2 Lower the pitcher onto the motor base. The handle should be aligned slightly to the right and the pitcher should be oriented so the **LOCK** symbols are visible on the motor base. Rotate the pitcher clockwise until it clicks into place.

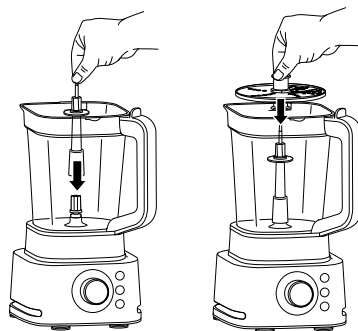

- 3 Place the disc spindle onto the drive gear inside the pitcher. Then, use the plastic grip to grasp the disc and place it over the spindle.

NOTE: The slicing/shredding disc is reversible. Ensure you place the side you would like to use facing up.

NOTE: Grating disc is not available with all models.

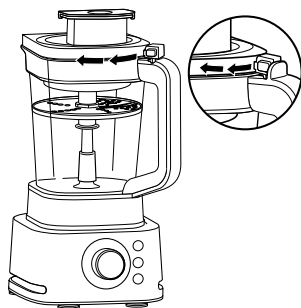

- 4 To install the feed chute lid on the pitcher, place the lid tab to the right of the handle. Press the lid down until it is secure. Rotate the tab clockwise until it clicks into place on the pitcher handle. Once the lid is locked in place, press the Power button to turn unit on.



- 5a To use the DISC Auto-iQ program, press START/STOP.

- 5b For Manual mode, press IQ/MANUAL. With speed 1 on the display, press START/STOP.

NOTE: Only speed 1 is available when using the feed chute lid and disc assemblies.

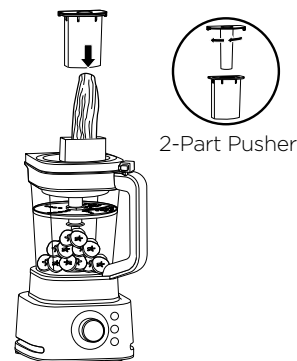

- 6a Add the prepped ingredients you want to slice, shred, or grate through the feed chute on the lid. Use the 2-part food pusher to help guide the food through the feed chute. The middle piece of the food pusher is removable to use for narrow ingredients. **DO NOT** process ingredients past the **DISC MAX** line on the pitcher.

NOTE: DO NOT force ingredients through the feed chute.

- 7a If using the DISC program, this preset feature will automatically stop at the end of the program.

- 7b If using Manual mode, press START/STOP when processing is complete. Wait for the unit to come to a complete stop.

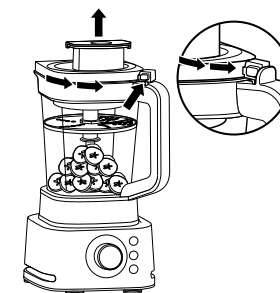

- 8 To remove the lid from the pitcher, press the release button above the pitcher handle, and rotate the lid tab counterclockwise out of the lock position, then lift the entire lid up.

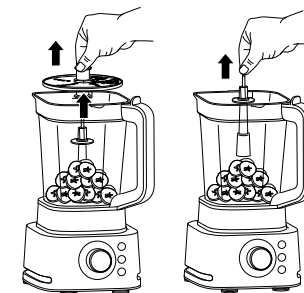

- 9 Using the plastic grip, carefully lift the disc out of the pitcher. Then, grasp the spindle by the top of the shaft and lift it out of the bowl.

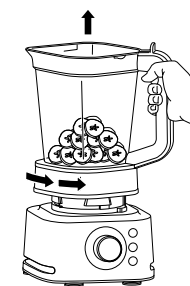

- 10 Remove the pitcher from the motor base by turning it counterclockwise and then lifting up.

- 11 Turn the unit off by pressing the Power button. Unplug the unit when finished. Refer to the Care & Maintenance section for cleaning and storage instructions.

USING THE POWER BLENDER & PROCESSOR PITCHER WITH FLAT LID & STACKED BLADE ASSEMBLY

IMPORTANT: Review all warnings on pages 4–7 before proceeding.

IMPORTANT: As a safety feature, when the unit is powered on, if the pitcher and lid are not properly installed, the timer will display “- -” and the motor will be disabled. If this happens, repeat step 5. When the pitcher and lid are properly installed, and the unit is powered on, the available programs will illuminate, indicating the appliance is ready to use.

NOTE: DO NOT add ingredients before completing installation of the stacked blade assembly.

NOTE: If the stacked blade assembly is not fully seated, you will not be able to install and lock the lid.

NOTE: The pitcher lid handle will not fold down unless it is attached to the pitcher.

- 1 Plug in motor base and place on a clean, dry, level surface such as a countertop or table.

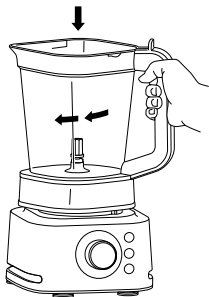

- 2 Lower the pitcher onto the motor base. The handle should be aligned slightly to the right and the pitcher should be oriented so the **LOCK** symbols are visible on the motor base. Rotate the pitcher clockwise until it clicks into place.

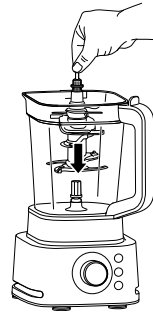

- 3 Exercising care, grasp the stacked blade assembly by the top of the shaft and place it onto the drive gear inside the pitcher. Note that the blade assembly will fit loosely onto the drive gear.
- 4 Add ingredients to the pitcher. **DO NOT** add ingredients past the **MAX LIQUID** line on the pitcher.

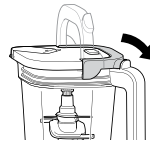

- 5 Place the flat lid on the pitcher. Press down on the handle until it clicks into place. Once the lid is locked in place, press the Power button to turn unit on. The available program buttons will illuminate and the unit will be ready for use.



- 6a If using an Auto-iQ program, use the dial to select the program that best suits your desired output, then press **START/STOP**. The preset feature will automatically stop at the end of the program. To stop the unit at any time, press **START/STOP**.
- 6b For Manual mode, press **IQ/MANUAL**. Use the dial to select your desired speed, ranging from 1 to 10, and press **START/STOP**. Once the ingredients have reached your desired consistency, press **START/STOP**, and wait for the unit to come to a complete stop.

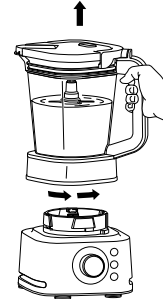

- 7 Remove the pitcher from the motor base by turning it counterclockwise and then lifting up.

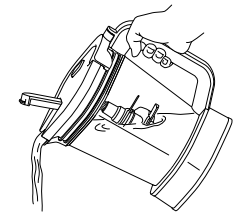

- 8a To pour out thinner mixtures, ensure the lid is locked in place, then open the pour spout cap.

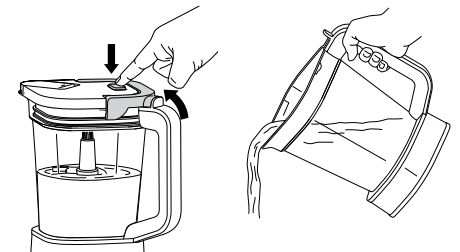

- 8b For thicker mixtures that cannot be emptied through the pour spout, remove the lid and stacked blade assembly before pouring. To remove the lid, press the **RELEASE** button and lift the handle. To remove the blade assembly, carefully grasp it by the top of the shaft and pull straight up. The pitcher can then be emptied.

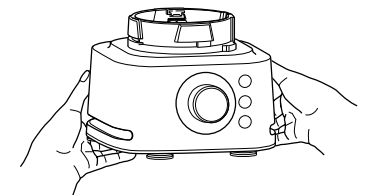

- 9 Turn the unit off by pressing the Power button. Unplug the unit when finished. Refer to the Care & Maintenance section for cleaning and storage instructions.

USING THE POWER BLENDER & PROCESSOR PITCHER WITH FLAT LID & DOUGH BLADE ASSEMBLY

IMPORTANT: Review all warnings on pages 4-7 before proceeding.

IMPORTANT: As a safety feature, when the unit is powered on, if the pitcher and lid are not properly installed, the timer will display "--" and the motor will be disabled. If this happens, repeat step 5. When the pitcher and lid are properly installed, and the unit is powered on, the available programs will illuminate, indicating the appliance is ready to use.

NOTE: DO NOT add ingredients before completing installation of the dough blade assembly.

NOTE: If the dough blade assembly is not fully seated, you will not be able to install and lock the lid.

NOTE: The pitcher lid handle will not fold down unless it is attached to the pitcher.

- 1 Plug in motor base and place on a clean, dry, level surface such as a countertop or table.

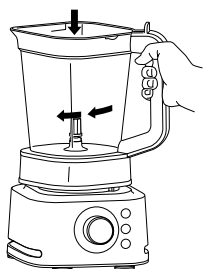

- 2 Lower the pitcher onto the motor base. The handle should be aligned slightly to the right and the pitcher should be oriented so the **LOCK** symbols are visible on the motor base. Rotate the pitcher clockwise until it clicks into place.

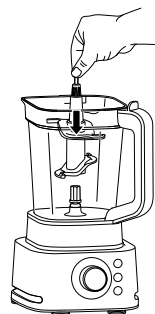

- 3 Exercising care, grasp the dough blade assembly by the top of the shaft and place it onto the drive gear inside the pitcher. Note that the blade assembly will fit loosely onto the drive gear.



- 4 Add ingredients to the pitcher. **DO NOT** add ingredients past the **DOUGH MAX (MAX PÂTE)** or **COOKIE MAX (MAX BISCUIT)** line on the pitcher.



- 5 Place the flat lid on the pitcher. Press down on the handle until it clicks into place. Once the lid is locked in place, press the Power button to turn unit on. The available program buttons will illuminate and the unit will be ready for use.



- 6a If using an Auto-iQ® program, use the dial to select **DOUGH**, then press **START/STOP**. The preset feature will automatically stop at the end of the program. To stop the unit at any time, press **START/STOP**.

- 6b For Manual mode, press **IQ/MANUAL**. Use the dial to select speed 1, then press **START/STOP**. Once the ingredients have reached your desired consistency, press **START/STOP**, and wait for the unit to come to a complete stop.

IMPORTANT: Only use speed 1 when using the dough blade assembly.

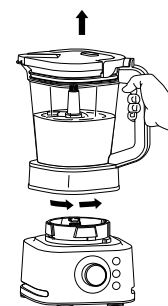

- 7 Remove the pitcher from the motor base by turning it counterclockwise and then lifting up.

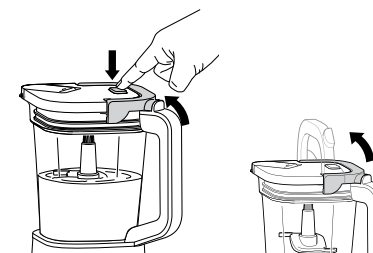

- 8 Remove the lid and dough blade assembly before removing contents. To remove the lid, press the release button above the handle, and rotate the lid tab counterclockwise out of the lock position, then lift the entire lid up.

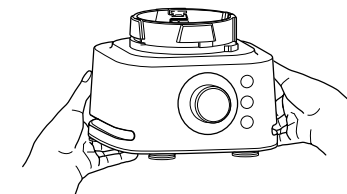

- 9 Turn the unit off by pressing the Power button. Unplug the unit when finished. Refer to the Care & Maintenance section for cleaning and storage instructions.

USING THE XL POWER SMOOTHIE BOWL

IMPORTANT: Review all warnings on pages 4-7 before proceeding.

NOTE: If the unit is plugged in and powered on, but the XL bowl and blade assembly is not properly installed, the timer will display "--" and the motor will be disabled.

- 1 Plug in motor base and place on a clean, dry, level surface such as a countertop or table.



- 2 Add ingredients to the XL Power Smoothie Bowl. **DO NOT** add liquid past the **LIQUID FILL** line or ingredients past the **MAX FILL** line.



- 3 Place the Hybrid Edge Blades Assembly on the top of the smoothie bowl and turn clockwise to seal.

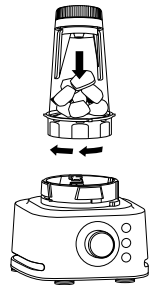

- 4 Turn the XL smoothie bowl upside down and install on motor base by aligning the tabs on the smoothie bowl with the slots on the base. Then, rotate smoothie bowl clockwise until it clicks. Once locked in place, press the Power button to turn unit on. The available program buttons will illuminate and the unit will be ready for use.

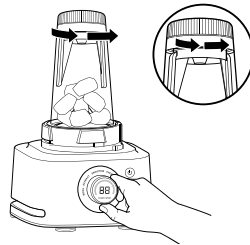

NOTE: While processing, twist the built-in tamper *counterclockwise* continuously.

- 5a If using an Auto-iQ program, use the dial select the program that best suits your desired output, then press START/STOP. During the blending process, ensure to twist the built-in tamper **counterclockwise** continuously. The preset feature will automatically stop at the end of the program. To stop the unit at any time, press START/STOP.

- 5b For Manual mode, press IQ/MANUAL. With speed 10 on the display, press START/STOP. During the blending process, twist the built-in tamper **counterclockwise** continuously. Once the ingredients have reached your desired consistency, press START/STOP and wait for the unit to come to a complete stop.

NOTE: Only speed 10 is available when using the XL smoothie bowl.

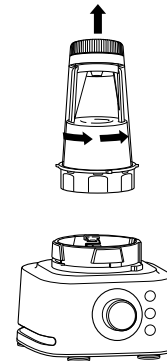

- 6 Remove the XL smoothie bowl from the motor base by turning it counterclockwise and then lifting up.



- 7 Remove the blade assembly by twisting counterclockwise. **DO NOT** store blended contents with the blade assembly attached. Only use the spout lid or storage lid to cover. Exercise care when handling the blade assembly, as the blades are sharp.



- 8 To enjoy on the go, place the spout lid or storage lid onto the smoothie bowl and twist lid clockwise until firmly sealed.

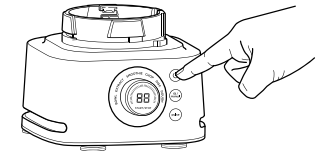

- 9 Turn the unit off by pressing the Power button. Unplug the unit when finished. Refer to the Care & Maintenance section for cleaning and storage instructions.

USING THE POWER NUTRI CUP*

IMPORTANT: Review all warnings on pages 4-7 before proceeding.

NOTE: If the unit is plugged in and powered on, but the cup and blade assembly is not properly installed, the timer will display “- -” and the motor will be disabled.

- 1 Plug in motor base and place on a clean, dry, level surface such as a countertop or table.



- 2 Add liquid then ingredients to the Power Nutri Cup. **DO NOT** add ingredients past the **MAX LIQUID** line.



- 3 Place the Hybrid Edge™ Blades Assembly on the top of the cup and turn clockwise to seal.

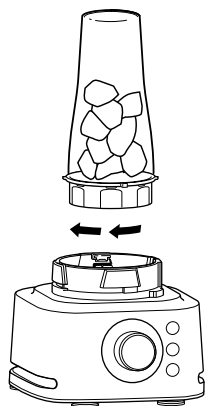

- 4 Turn the cup upside down and install on the motor base by aligning the tab on the cup with the slots on the base. Then, rotate cup clockwise until it clicks. Once locked in place, press the Power button to turn unit on. The available program buttons will illuminate and the unit will be ready for use.

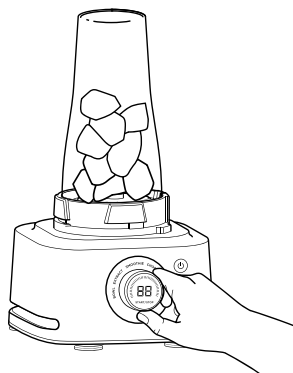

- 5a If using an Auto-iQ program, use the dial to select the program that best suits your desired output, then press START/STOP. The preset feature will automatically stop at the end of the program. To stop the unit at any time, press START/STOP.

- 5b For Manual mode, press IQ/MANUAL. With speed 10 on the display, press START/STOP. Once the ingredients have reached your desired consistency, press START/STOP and wait for the unit to come to a complete stop.

NOTE: Only speed 10 is available when using the single-serve cup.

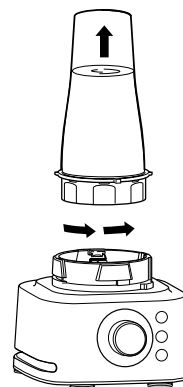

- 6 Remove the cup from the motor base by turning it counterclockwise and then lifting up.



- 7 Remove the blade assembly by twisting counterclockwise. **DO NOT** store blended contents with the blade assembly attached. Only use the spout lid or storage lid to cover. Exercise care when handling the blade assembly, as the blades are sharp.



- 8 To enjoy on the go, place the spout lid or storage lid onto the cup and twist lid clockwise until firmly sealed.

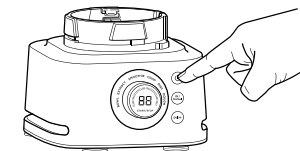

- 9 Turn the unit off by pressing the Power button. Unplug the unit when finished. Refer to the Care & Maintenance section for cleaning and storage instructions.

*Extract a drink containing vitamins and nutrients from fruits and vegetables.

USING THE NINJA COFFEE & SPICE GRINDER

IMPORTANT: Review all warnings on pages 4-7 before proceeding.

- 1 Add ingredients to the stainless steel grinding cup. Use the measurement lines on the grinding cup for added convenience. **DO NOT** exceed 12 tablespoons.

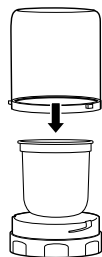

- 2 Place the lid onto the blade assembly with stainless steel grinding cup so the tabs on the cup meet the entry point on the blade assembly. Twist until the lid is locked in place.

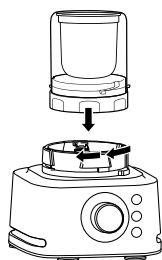

- 3 Place the grinder onto the motor base, aligning the tabs on the grinder with the slots on the base. Then, rotate clockwise until it clicks into place. Once locked in place, the programs will illuminate and the unit will be ready for use.

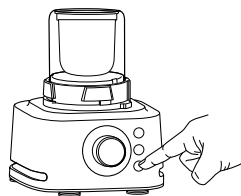

- 4 Select iQ/Manual. Use the dial to select your blender model's highest speed, then press START/STOP. Blend until desired consistency is reached. Press START/STOP again to end the program and wait for the unit to come to a complete stop. Or, use PULSE.

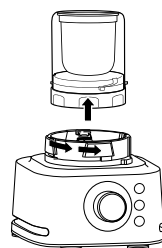

- 5 Remove the grinder from the motor base by turning it counterclockwise then lifting up.

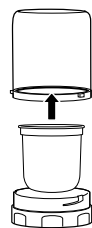

- 6 Remove the lid and empty contents. Be sure to store the grinder with the lid attached to the blade assembly with the stainless steel cup.

GRINDER CHARTS

GRINDING COFFEE CHART

Use these grind times for your ideal brew.

WHOLE BEANS	FRENCH PRESS	DRIP COFFEE MAKER	ESPRESSO
4-12 tbsp.	15 sec.	20 sec.	25 sec.
Select START/STOP or run on your blender model's highest speed.			

NOTE: For best results, we do not recommend grinding less than 4 tablespoons of coffee beans.

GRINDING SPICES CHART

Make spice blends to flavor your favorite dishes

WHOLE SPICE*	COARSE	MEDIUM	FINE
1-6 tbsp.	10 sec.	15 sec.	25 sec.
7-12 tbsp.	10 sec.	20 sec.	30 sec.
Select START/STOP or run on your blender model's highest speed.			

*Grind times shown are for these four popular spices: black peppercorns, cumin, coriander, and fennel.

MILLING CHART

Add your freshly ground powders—such as flax meal and chia meal—to smoothies, extracts, smoothie bowls, and nut butters for more fibre and nutrients.

WHOLE SPICE*	COARSE	MEDIUM	FINE
1-6 tbsp.	20 sec.	30 sec.	40 sec.
7-12 tbsp.	20 sec.	35 sec.	45 sec.
Select START/STOP or run on your blender model's highest speed.			

FLAVORED POWDERS CHART

Add your freshly ground flavoring powders—such as strawberry, raspberry, and blueberry—to smoothies, extracts, smoothie bowls, sorbets, and frozen yogurt to amplify favor and add a burst of color.

FREEZE DRIED FRUIT**	COARSE	MEDIUM	FINE
1-6 tbsp.	10 sec.	15 sec.	25 sec.
7-12 tbsp.	10 sec.	20 sec.	30 sec.
Select START/STOP or run on your blender model's highest speed.			

**DO NOT grind frozen fruit, only freeze-dried fruits.

CARE & MAINTENANCE

USING THE BLENDER FOR STUCK-ON INGREDIENTS

NOTE: For best results, use a dishwasher to remove stuck-on ingredients.

- 1 After processing, immediately clean the container and blade assembly under warm, soapy water.
- 2 Depending on the container, fill with soap and water according to the following instructions:

2.1 L Pitcher & Flat Lid:

1 OR 2 SMALL DROPS OF DISH SOAP

FILL WATER TO DOUGH MAX LINE



With the dough or stacked blade assembly installed, fill with warm water up to DOUGH MAX line and add 1 or 2 small drops dish soap. Secure flat lid, and ensure the pour spout is securely closed.

XL Power Smoothie Bowl:

1 OR 2 SMALL DROPS OF DISH SOAP

FILL WATER TO TOP OF BUILT-IN TAMPER



Fill with warm water up to top of built-in tamper and add 1 or 2 small drops dish soap. Install blade assembly.

NOTE: If using the XL smoothie bowl, twist the built-in tamper counterclockwise *continuously* while cleaning.

Single-Serve Cup:

1 SMALL DROP OF DISH SOAP

FILL WATER HALFWAY



Fill halfway with warm water and add 1 small drop dish soap. Install blade assembly.

- 3 Install the container on the motor base. Select BOWL, then press START/STOP.
- 4 Once program is complete, thoroughly rinse container and blade assembly under warm, soapy water.

CLEANING

Hand-Washing

Wash containers, lids, discs, and blade assemblies in warm, soapy water. Use a dishwashing utensil with a handle to avoid direct contact with the blades. Exercise care when handling the blade assembly as the blades are sharp. Thoroughly rinse and air-dry all parts.

NOTE: The built-in tamper in the XL smoothie bowl is not removable.

Dishwasher

Containers, lids, discs and blade assemblies are dishwasher safe. Ensure the blade assembly and lid are removed from the container before placing in the dishwasher.

NOTE: For best results, use a dishwasher to remove stuck-on ingredients.

Motor Base

Unplug the motor base before cleaning. Wipe motor base with a clean, damp cloth. **DO NOT** use abrasive cloths, pads, or brushes to clean the base.

STORING

To purchase a storage case to house most attachments that come with this unit, visit **AU** ninjakitchen.com.au or **NZ** ninjakitchen.co.nz.

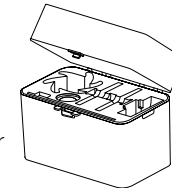

Store the Hybrid Edge Blades Assembly with the single-serve cup and the storage lid with the XL smoothie bowl.

For cord storage, wrap cord with hook-and-loop fastener near the back of the motor base. **DO NOT** wrap the cord around the bottom of the base for storage.

DO NOT store blended or unblended ingredients in the cup or XL smoothie bowl with the blade assembly attached.

DO NOT stack items on top of the containers. Store any remaining attachments alongside the unit or in a cabinet where they will not be damaged or create a hazard.

RESETTING THE MOTOR

This unit features a unique safety system that prevents damage to the motor and drive system should you inadvertently overload it. If the unit is overloaded, the motor will be temporarily disabled. Should this occur, follow the reset procedure below.

- 1 Unplug the unit from the electrical outlet.
- 2 Allow the unit to cool for approximately 15 minutes.
- 3 Remove the container's lid and blade assembly. Empty the container and ensure no ingredients are jamming the blade assembly.

IMPORTANT: Ensure that maximum capacities are not exceeded. This is the most typical cause of appliance overload.

ORDERING REPLACEMENT PARTS

To order additional parts and attachments, visit **AU** ninjakitchen.com.au or **NZ** ninjakitchen.co.nz

TROUBLESHOOTING GUIDE

⚠ WARNING: To reduce the risk of shock and unintended operation, turn power off and unplug unit before troubleshooting.

Display reads “- -”.

- If the display reads “- -”, install a container and the available program buttons will illuminate, indicating the unit is ready for use. Ensure the lid is fully engaged and the container has been rotated clockwise and clicked to lock into place.
- If vessel is properly installed and the display reads “- -”, ensure the interior of the base area is clean of any debris.

Display reads “E1”.

- If the display reads “E1”, unplug the unit from the electrical outlet and allow it to cool for 15 minutes. Remove the blade assembly and empty the contents to ensure no ingredients are jamming the blade assembly.

Display reads “E2”.

- If the display reads “E2” unplug the unit from the electrical outlet and allow it to cool for 5 minutes. Remove the blade assembly and empty the contents to ensure no ingredients are jamming the blade assembly. If output is too thick and ingredients are not processing properly, add more liquid.

Blade speed sometimes changes when blending thinner ingredients.

- When using speed 9 or 10 with the pitcher, you may notice a change in the blade speed when blending thinner ingredients. This is due to the smart technology in the blender and is part of the unit’s normal operation.

Unit doesn’t mix well; ingredients get stuck.

- Using the Auto-iQ programs is the easiest way to achieve great results. The pulses and pauses allow the ingredients to settle toward the blade assembly. If ingredients are routinely getting stuck, adding some liquid will usually help.
- When filling the cup, start with fresh fruit or veggies, then leafy greens or herbs. Next add liquids or yogurt, then seeds, powders, or nut butters. Finally, add ice or frozen ingredients.
- If using the XL smoothie bowl, during the blending process twist the built-in tamper counterclockwise continuously to circulate ingredients.

Unit moves on counter while blending.

- Make sure the surface and feet of the unit are clean and dry.

Preset program will not work.

- The unit can detect which container is on the motor base. You may be trying to use a program that is not designed for the container or lid you have installed. The programs will light up, indicating which programs are available for each container.

Food is not evenly chopped.

- For best results when chopping, cut pieces of ingredients in a uniform size and don’t overfill the Pitcher. Refer to the Quick Start Guide or Inspiration Guide for food prep instructions.

Can’t remove the built-in tamper from the XL smoothie bowl.

- The built-in tamper in the XL smoothie bowl is not removable. For cleaning instructions, refer to the Care & Maintenance section.

All ten speed ranges are not available when using the XL smoothie bowl, the single-serve cup, or the feed chute lid and disc assemblies.

- Only speed 10 is available when using the XL smoothie bowl or single-serve cup, and only speed 1 is available when using feed chute lid and disc assemblies.
- All 10 speed ranges are available when using the pitcher and stacked blade assembly.
IMPORTANT: Only use speed 1 when using the dough blade assembly.

Cannot install feed chute lid onto pitcher.

- Thoroughly wash the handle of the pitcher with soap and water where the lid connects to the pitcher.
- Check to ensure the desired disc is fully seated on the disc spindle.

Ingredients are unevenly sliced.

- For best results when using the reversible slicing/shredding disc, trim ingredients to a uniform size so they fit better through the feed chute. Do not cut ingredients smaller than the feed chute height. **DO NOT** attempt to force ingredients through the feed chute.

Mann&Noble

ONE (1) YEAR LIMITED REPLACEMENT WARRANTY

The warranty commences on the date of purchase and expires at the end of the 1 year period. In the unlikely event of a defect due to faulty materials or workmanship within the guarantee period we will replace the defective/faulty part with a new product, free of charge, or if the unit is deemed defective/faulty we replace the unit with an equivalent or upgraded model, at our discretion.

For warranty claims, you will need to submit a proof of purchase in the form of a valid receipt that displays date and place of purchase.

Replacement items will be covered by the limited warranty for the balance of the warranty period from the date of the original purchase. Please note:

Your warranty is subject to the following conditions:

- **DO NOT** operate the appliance with a damaged plug or cord, or if the unit has been dropped, damaged or dropped in water.
- To avoid the risk of electric shock, do not disassemble or attempt to repair the appliance on your own. If the supply cord is damaged, it must be replaced by a qualified electrician to avoid a hazard. Incorrect re-assembly or repair can cause a risk of electric shock or injury to persons when the appliance is used.
- The item has not been misused, abused, neglected, altered, modified or repaired by anyone.
- The item has been subjected to fair wear and tear.
- The item has not been used for trade, professional or hire purposes.
- The item has not sustained damage through foreign objects, substances or accident
- Accidental damage
- Damage as a result of use not in accordance with the rating plate
- Use of parts and accessories that are not genuine Ninja components

Customer costs within warranty

- The customer is responsible for any inwards freight charge to return a product for warranty if requested, and outward freight charge for warranty parts and or replacement unit.

Who is covered?

- This warranty applies only to the original purchaser, who bought the product from an authorised retailer and may not be transferred. Proof of purchase is required.

What is not covered?

- Accessories supplied with the item.
- Components that are subject to natural wear and tear caused by normal use in accordance with operating instructions.
- Unauthorised/improper maintenance/handling or overload is excluded from this warranty.

Mann&Noble Pty Ltd
Building D, 33 Quarry Road
Erskine Park NSW, Australia, 2759
AU 02 8801 7666 | NZ 0800 112 660
AU ninjakitchen.com.au | NZ ninjakitchen.co.nz

Illustrations may differ from actual product. We are constantly striving to improve our products, therefore the specifications contained herein are subject to change without notice.

AUTO-IQ, FOODI, NINJA, and TOTAL CRUSHING are registered trademarks of SharkNinja Operating LLC.

HYBRID EDGE and POWER NUTRI are trademarks of SharkNinja Operating LLC.

© 2022 SharkNinja Operating LLC

CB402ANZ_IB_MP_Mv8_220520

