

NINJA[®]

BN500ANZ

INSTRUCTIONS

BLENDER PRO WITH AUTO-IQ[®]



AU ninjakitchen.com.au
NZ ninjakitchen.co.nz

THANK YOU FOR PURCHASING

your Ninja® Blender

REGISTER YOUR PURCHASE



AU ninjakitchen.com.au

NZ ninjakitchen.co.nz

RECORD THIS INFORMATION

Model Number: _____

Serial Number: _____

Date of Purchase: _____

(Keep receipt)

Store of Purchase: _____

TECHNICAL SPECIFICATIONS

Voltage: 220-240V~, 50-60Hz

Power: 1000 Watts

**PLEASE READ CAREFULLY AND
KEEP FOR FUTURE REFERENCE.**

CONTENTS

Important Safeguards	4
Getting to Know Your Ninja® Blender	6
Before First Use	6
Using The Control Panel	7
Auto-iQ® Programs	7
Manual Programs	7
Blending Instructions	8
Care & Maintenance	10
Cleaning.....	10
Storing.....	10
Resetting the Motor Thermostat	10
Troubleshooting Guide	11
Warranty	12

VISIT US ONLINE AT:
AU ninjakitchen.com.au
NZ ninjakitchen.co.nz



Or follow us on any of our social media pages:



@ninjakitchenapac

IMPORTANT SAFEGUARDS

HOUSEHOLD USE ONLY • READ ALL INSTRUCTIONS BEFORE USE

	Read and review instructions for operation and use.
	Indicates the presence of a hazard that can cause personal injury, death or substantial property damage if the warning included with this symbol is ignored.
	For indoor and household use only.
When using electrical appliances, basic safety precautions should always be followed, including the following:	

WARNING

To reduce the risk of fire, electric shock, serious injury, death or damage when using this appliance, follow these basic safety precautions.

General Precautions

- 1 Read all instructions prior to using the appliance and its accessories.
- 2 Carefully observe and follow all warnings and instructions. This unit contains electrical connections and moving parts that potentially present risk to the user.
- 3 **ALWAYS** exercise care when handling the Pro Extractor Blades™ Assembly. The blades are sharp. **ONLY** grasp the Pro Extractor Blades Assembly by the outer perimeter of the blade assembly base. Failure to use care when handling the blade assembly will result in a risk of laceration.
- 4 Take your time and exercise care during unpacking and appliance setup. This appliance contains sharp, loose blades that can cause injury if mishandled.
- 5 Take inventory of all contents to ensure you have all parts needed to properly and safely operate your appliance.
- 6 Turn the appliance **OFF**, then unplug the appliance from the socket when not in use, before assembling or disassembling parts, and before cleaning. To unplug, grasp the plug by the body and pull from the socket. **NEVER** unplug by grasping and pulling the flexible cord.
- 7 Before use, wash all parts that may contact food. Follow washing instructions covered in this instruction manual.
- 8 Blades are sharp. Handle carefully.
- 9 To protect against the risk of electric shock, **DO NOT** submerge the appliance or allow the power cord to contact any form of liquid.
- 10 **DO NOT** use this appliance outdoors. It is designed for indoor household use only.
- 11 **DO NOT** operate any appliance with a damaged cord or plug, or after the appliance malfunctions or is dropped or damaged in any manner. This appliance has no user-serviceable parts. If damaged, contact SharkNinja for servicing.
- 12 **DO NOT** abuse the power cord. Never carry the appliance by the power cord or yank it to disconnect from electrical socket; instead grasp the plug and pull to disconnect.
- 13 Extension cords should **NOT** be used with this appliance.
- 14 This appliance shall not be used by children. Keep the appliance and its cord out of reach of children.
- 15 Appliances can be used by persons with reduced physical, sensory or mental capabilities or lack of experience and knowledge if they have been given supervision or instruction concerning use of the appliance in a safe way and if they understand the hazards involved.
- 16 Children should not play with the appliance.
- 17 Before each use, inspect blade assemblies for damage. If a blade is bent or damage is suspected, contact SharkNinja to arrange for replacement.
- 18 **DO NOT** attempt to sharpen blades.
- 19 **DO NOT** misuse the appliance to avoid potential injury.
- 20 Care shall be taken when handling the sharp cutting blades, emptying the bowl and during cleaning.
- 21 Always disconnect the appliance from the supply if it is left unattended and before assembling, disassembling or cleaning.

-
- 22 DO NOT** allow the unit or the cord to hang over the edges of tables or worktops. The cord may become snagged and pull the appliance off the work surface.
 - 23 DO NOT** allow any part of the unit to contact hot surfaces, including stoves and other heating appliances.
 - 24 ALWAYS** use the appliance on a dry and level surface.
 - 25 NEVER** place a blade assembly on the motor base without it first being attached to its corresponding container (bowl, pitcher, cup) and lid.
 - 26 ONLY** use attachments and accessories that are provided with the product or are recommended by SharkNinja. The use of attachments not recommended or sold by SharkNinja may cause fire, electric shock or injury.
 - 27** During operation and handling of the appliance, avoid contact with moving parts.
 - 28 DO NOT** operate the appliance with an empty container.
 - 29 DO NOT** fill containers past the **MAX FILL** or **MAX LIQUID** lines.
 - 30 DO NOT** microwave any containers or accessories provided with the appliance.
 - 31 DO NOT** perform grinding operations with the Single-Serve Cup and Pro Extractor Blades™ Assembly.
 - 32** Before operation, ensure all utensils are removed from containers. Failure to remove utensils can cause containers to shatter and potentially result in personal injury and property damage.
 - 33** Keep hands, hair, clothing, as well as utensils out of container while processing to reduce the risk of severe injury to persons or damage to the appliance. A scraper may be used but only when the appliance is not running.
 - 34 NEVER** operate the appliance without lids and caps in place. **DO NOT** attempt to defeat the interlock mechanism. Ensure the container and lid are properly installed before operation.
 - 35 DO NOT** expose the containers and accessories to extreme temperature changes. They may experience damage.
 - 36 NEVER** leave the appliance unattended while in use.
 - 37 DO NOT** blend hot liquids. Doing so may result in pressure buildup and steam exposure that can pose a risk of the user being burned.
 - 38 DO NOT** attempt to remove the container and lids from the motor base while the blade assembly is still spinning. Allow the appliance to come to a complete stop before removing lid and container.
 - 39** Remove the Pro Extractor Blades Assembly from the Single-Serve Cup upon completion of blending. **DO NOT** store ingredients before or after blending them in the cup with the blade assembly attached. Some foods may contain active ingredients or release gases that will expand if left in a sealed container, resulting in excessive pressure buildup that can pose a risk of injury. For ingredient storage in the cup, use only Spout Lid to cover.
 - 40** The maximum wattage rating for this appliance is based on the configuration of the Pro Extractor Blades Assembly and Single-Serve Cup. Other configurations may draw less power or current.
 - 41** If you find unmixed ingredients sticking to the sides of the cup, stop the appliance, remove the blade assembly, and use a scraper to dislodge ingredients.
 - 42 DO NOT** process dry ingredients without adding liquid to the Single-Serve Cup. The Single-Serve Cup is not intended for dry blending.
 - 43** To protect against risk of electrical shock, **DO NOT** immerse the motor base in water or other liquid.
 - 44** If the appliance overheats, a thermal switch will activate and temporarily disable the motor. To reset, unplug the appliance and allow it to cool for approximately 15 minutes before using again.

SAVE THESE INSTRUCTIONS

GETTING TO KNOW YOUR NINJA® PERSONAL BLENDER

MAIN UNIT

- A** Spout Lid
- B** 500ml Single Serve Cups*
- C** 700ml Single Serve Cups**
- D** 900ml Single Serve Cups***
- E** Pro Extractor Blades™ Assembly
- F** Motor Base with Power Cord

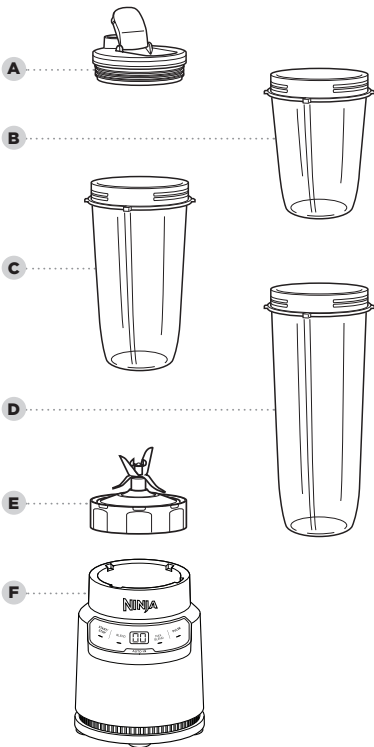

NOTE: Number and size of Single-Serve Cups/Spout Lids vary by model.

To order additional parts and accessories, visit **AU** ninjakitchen.com.au
NZ ninjakitchen.co.nz

*400ml. max liquid capacity.
**600ml. max liquid capacity.
***800ml. max liquid capacity.

BEFORE FIRST USE

DID YOU KNOW?

- You can take your drinks on the go using the Spout Lids.
- The containers, blade assemblies and lids are BPA free and dishwasher safe.

NOTE: Handle the Pro Extractor Blades Assembly by grasping around the perimeter of the blade assembly base.

NOTE: All attachments are dishwasher safe. It is recommended that the lids, containers and blade assemblies be placed on the top rack of the dishwasher. Ensure blade assemblies and lids are removed from their containers before placing in the dishwasher. Exercise care when handling blade assemblies.

- 1** Remove all packaging materials from the appliance. Exercise care when unpacking blade assemblies. All blade assemblies are sharp.
- 2** Wash containers, lids and blade assemblies in warm, soapy, water using a dishwashing utensil with a handle to avoid direct contact with the blades. Exercise care when handling blade assemblies, as the blades are sharp.
- 3** Thoroughly rinse and air-dry all parts.
- 4** Wipe screen with a soft, damp cloth. Allow it to dry completely before using.

USING THE CONTROL PANEL

AUTO-IQ® PROGRAMS

Intelligent pre-set programs combine unique blending and pausing patterns that do the work for you. Once a pre-set program is selected, it will start immediately and automatically stop when blending is complete. To stop blending before the end of the program, press START/STOP or the currently active button again.



AUTO-IQ PROGRAMS:

BLEND

Make drinks containing fresh or frozen fruit, liquids and ice or blend together purees and more. Program lasts for 45 seconds.

MAX BLEND

Ideal for tougher ingredients including skins, seeds and stems. Program lasts for 60 seconds.

MANUAL PROGRAMS:

NOTE: Manual programs cannot be used in conjunction with any Auto-iQ programs.

START | STOP

Press once to start continuous running; press again to stop. Timer counts up by seconds, up to 60 seconds.

PULSE

Runs only while pressed down. Short presses create short pulses. Timer counts up by seconds as long as button is pressed down.

BLENDING INSTRUCTIONS

IMPORTANT: Review all warnings on pages 4-5 before proceeding.

- 1 Plug in motor base and place on a clean, dry, level surface such as a worktop or table.



- 2 Add ingredients to the Single-Serve Cup. **DO NOT** add ingredients past the **MAX LIQUID** line on the cup.

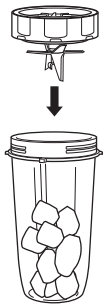

- 3 Place the Pro Extractor Blades Assembly on the top of the cup and turn clockwise to seal.
- 4 Turn the cup upside down and install on the motor base by aligning the tabs on the cup with the slots on the base. Then, rotate cup clockwise until it clicks. Once locked in place, the programs will illuminate and the unit will be ready for use.

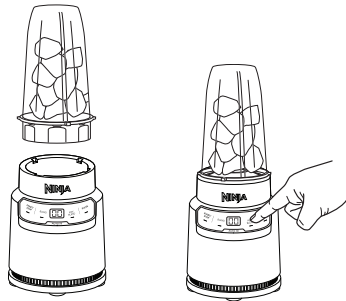

- 5a If using an Auto-iQ program, select the program that best suits your desired output. The preset feature will automatically stop at the end of the program. To stop the unit at any time, press the currently active program again.
- 5b If using START/STOP, once the ingredients have reached your desired consistency, press START/STOP again and wait for the unit to come to a complete stop.

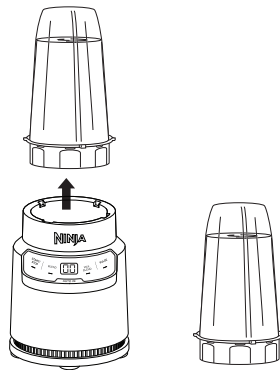

- 6 Remove the cup from the motor base by turning it anti-clockwise and then lifting up.

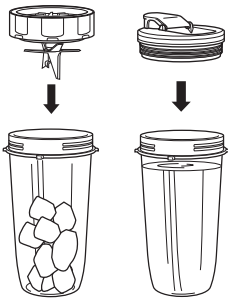

- 7** Remove the blade assembly by twisting anti-clockwise. **DO NOT** store blended contents with the blade assembly attached. Only use the Spout Lid to cover. Exercise care when handling the blade assembly, as the blades are sharp.



- 8** To enjoy on the go, place the Spout Lid onto the cup and twist lid clockwise until firmly sealed.
- 9** Unplug the unit when finished. Refer to the Care & Maintenance section for storing instructions.

CARE & MAINTENANCE

CLEANING

- 1 Separate all parts.
 - 2 Wash all containers in warm, soapy water with a soft cloth.
- **Hand-Washing**
Wash cups, lids, and blade assembly in warm, soapy water. Use a dishwashing utensil with a handle to avoid direct contact with the blades. Exercise care when handling the blade assembly as the blades are sharp. Thoroughly rinse and air-dry all parts.
 - **Dishwasher**
Cups, lids, and blade assembly are dishwasher safe. Place the cups, lids and blade assembly on the top rack of the dishwasher **ONLY**. Ensure the blade assembly and lid are removed from the cup before placing in the dishwasher.
 - **Motor Base**
Turn off the unit and unplug the motor base before cleaning. Wipe motor base with a clean, damp cloth.
NEVER directly spray the base with water or other liquids.
DO NOT use abrasive cloths, pads or brushes to clean the base, as this can dull or scratch the surface.

STORING

Wrap the power cord around the cord wrap on the underside of the motor base. Store the unit upright and with the blade assembly attached to the single-serve cup.

DO NOT store blended or unblended ingredients in the cup with the blade assembly attached. Use only the spout lid when storing blended and unblended ingredients in the containers.

DO NOT stack items on top of the cups. Store any remaining attachments alongside the unit or in a cupboard where they will not be damaged or create a hazard.

RESETTING THE MOTOR THERMOSTAT

This unit features a safety system that prevents damage to the motor and drive system should you inadvertently overload it. If the unit is overloaded, the motor will be temporarily disabled. Should this occur, follow the reset procedure below.

- 1 Unplug the unit from the socket.
- 2 Allow the unit to cool for approximately 15 minutes.
- 3 Remove the container's lid and blade assembly. Empty the container and ensure no ingredients are jamming the blade assemblies.

IMPORTANT: Ensure that maximum capacities are not exceeded. This is the most typical cause of appliance overload.

TROUBLESHOOTING GUIDE

WARNING: To reduce the risk of shock and unintended operation, turn power off and unplug unit before troubleshooting.

Control panel does not illuminate.

- Make sure unit is plugged in. If the unit is powered on and no cup is installed, the unit will display '- -'. The available programs will illuminate after placing a cup on base and rotating it clockwise until it clicks into place.

Control panel doesn't turn off.

- Remove cup from base by rotating it anti-clockwise and lifting it up. The display with flash '- -'. Unplug the power cord from the electrical socket. If the unit remains plugged in, the display will time out after 3 minutes of inactivity. Press any button to wake the unit.

Display reads "Er".

- If the display reads "Er", unplug the unit from the electrical socket and allow it to cool for 15 minutes. Remove the blade assembly and empty the contents to ensure no ingredients are jamming the blade assembly.

Doesn't mix well; ingredients get stuck.

- Using the Auto-iQ programs is the easiest way to achieve great results. The pulses and pauses allow the ingredients to settle toward the blade assembly. If ingredients are routinely getting stuck, adding some liquid will usually help.
- When filling the cup, start with fresh fruit or vegetables then leafy greens or herbs. Next add liquids or yogurt, then seeds, powders or nut butters. Finally, add ice or frozen ingredients.

Unit moves on worktop while blending.

- Make sure the worktop and feet of the unit are clean and dry. Place the motor base on a smooth, clean and level surface. Do not place motor base on a rough or unlevel surface as the suction cup feet will not adhere properly.

Lid or Pro Extractor Blades Assembly is hard to install on the cup.

- Set the cup on a level surface. Carefully place the lid or blade assembly on the top of the cup and align the threads so the lid/blade assembly sits flat. Twist clockwise until you have a tight seal.

Mann&Noble

ONE (1) YEAR LIMITED REPLACEMENT WARRANTY

The warranty commences on the date of purchase and expires at the end of the 1 year period. In the unlikely event of a defect due to faulty materials or workmanship within the guarantee period we will replace the defective/faulty part with a new product, free of charge, or if the unit is deemed defective/faulty we replace the unit with an equivalent or upgraded model, at our discretion.

For warranty claims, you will need to submit a proof of purchase in the form of a valid receipt that displays date and place of purchase.

Replacement items will be covered by the limited warranty for the balance of the warranty period from the date of the original purchase. Please note:

Your warranty is subject to the following conditions:

- **DO NOT** operate the appliance with a damaged plug or cord, or if the unit has been dropped, damaged or dropped in water.
- To avoid the risk of electric shock, do not disassemble or attempt to repair the appliance on your own. If the supply cord is damaged, it must be replaced by a qualified electrician to avoid a hazard. Incorrect re-assembly or repair can cause a risk of electric shock or injury to persons when the appliance is used.
- The item has not been misused, abused, neglected, altered, modified or repaired by anyone.
- The item has been subjected to fair wear and tear.
- The item has not been used for trade, professional or hire purposes.
- The item has not sustained damage through foreign objects, substances or accident
- Accidental damage
- Damage as a result of use not in accordance with the rating plate
- Use of parts and accessories that are not genuine Ninja components

Customer costs within warranty

- The customer is responsible for any inwards freight charge to return a product for warranty if requested, and outward freight charge for warranty parts and or replacement unit.

Who is covered?

- This warranty applies only to the original purchaser, who bought the product from an authorised retailer and may not be transferred. Proof of purchase is required.

What is not covered?

- Accessories supplied with the item.
- Components that are subject to natural wear and tear caused by normal use in accordance with operating instructions.
- Unauthorised/improper maintenance/handling or overload is excluded from this warranty.

Proudly distributed by
Mann&Noble Pty Ltd
Building D, 33 Quarry Road
Erskine Park NSW, Australia, 2759
AU 02 8801 7666 | NZ 0800 112 660
AU ninjakitchen.com.au | NZ ninjakitchen.co.nz

Illustrations may differ from actual product. We are constantly striving to improve our products, therefore the specifications contained herein are subject to change without notice.

AUTO-IQ and NINJA are registered trademarks of SharkNinja Operating LLC.

PRO EXTRACTOR BLADES is a trademark of SharkNinja Operating LLC.

© 2022 SharkNinja Operating LLC

BN500ANZ_IB_MP_Mv3_220620

