

# NUTRI NINJA®

BL480ANZMN

OWNER'S GUIDE



# IMPORTANT SAFETY INSTRUCTIONS

## For Household Use Only

WHEN USING ELECTRICAL APPLIANCES, BASIC SAFETY PRECAUTIONS SHOULD ALWAYS BE FOLLOWED, INCLUDING THE FOLLOWING:

READ ALL INSTRUCTIONS BEFORE USING YOUR NUTRI NINJA® WITH AUTO-IQ®.

**⚠ WARNING:** Extension cords are not recommended for use with this product.

**⚠ WARNING:** The blades are not affixed to the unit. They are removable and very sharp. Handle with care!

**⚠ CAUTION:** In order to avoid a hazard due to inadvertent resetting of the thermal cut-out, this appliance must not be supplied through an external switching device, such as a timer, or connected to a circuit that is regularly switched on and off by the utility.

**IMPORTANT:** This appliance is not intended for use by persons with reduced physical, sensory or mental capabilities, or lack of experience and knowledge, unless they have been given supervision or instruction concerning use of the appliance by a person responsible for their safety.

Children shall not use or play with this appliance. Close supervision is necessary to keep appliance and cord out of reach of children during use.

### **⚠ WARNING:** TO REDUCE THE RISK OF FIRE, ELECTRIC SHOCK OR INJURY:

- 1 **⚠ WARNING:** Remove utensils prior to processing. Failure to remove may cause the jar to be damaged or to shatter which may cause personal injury.
- 2 **⚠ CAUTION:** Do not blend hot liquids, doing so may cause excessive pressure build-up, resulting in risk of the user being burned.
- 3 **⚠ CAUTION:** We do not recommend grinding in any of our Nutri Ninja Cups.
- 4 **⚠ CAUTION:** Remove the Pro Extractor Blades™ Assembly from the Nutri Ninja Cup upon completion of blending. Do not store ingredients before or after blending them in the cup or jar with the blade assembly attached. Some foods may contain active ingredients or release gases that will expand if left in a sealed container, resulting in excessive pressure buildup that can pose a risk of injury. For ingredient storage in the cup, use Sip & Seal® Lid or spout lid to cover.
- 5 **⚠ CAUTION:** Do not blend dry ingredients unless pulsing for short intervals per the instructions. Continuous blending dry ingredients will overheat the blender.
- 6 To protect against electrical shock, do not submerge the appliance or allow the power cord to come into contact with water or any other liquid.
- 7 **DO NOT** allow the appliance to be used by children. Close attention is necessary when used near children. This is not a toy.
- 8 Never leave an appliance unattended when in use.
- 9 Turn the appliance off and remove the power cord from the electrical outlet when not in use, before assembling or disassembling parts, accessing

parts that move while in use and before cleaning. To unplug, grasp the plug and pull from the electrical outlet. Never pull from the power cord.

- 10 **DO NOT** abuse the power cord. Never carry the appliance by the power cord or yank it to disconnect from electrical outlet; instead, grasp the plug and pull to disconnect.
- 11 **DO NOT USE** if the appliance is not working, has been dropped, dropped into water, damaged or left outdoors.
- 12 **NO SERVICEABLE PARTS.** Incorrect re-assembly or repair can cause a risk of electrical shock or injury to persons when the appliance is used. Contact Customer Service or Service Center for the repair or replacement under the warranty agreement.
- 13 If the supply cord is damaged, it must be replaced by the manufacturer, its service agent or similarly qualified persons in order to avoid a hazard.
- 14 **DO NOT** let the power cord hang over the edge of table or counter or touch hot surfaces such as the stove.
- 15 Always use the appliance on a dry, level surface.
- 16 Keep hands, hair, clothing, as well as utensils out of container while processing or blending to reduce the risk of severe injury to persons or damage to the appliance. A scraper may be used but only when the appliance is not running.
- 17 Avoid contact with moving parts.
- 18 **DO NOT** attempt to sharpen blades.
- 19 **DO NOT** use the appliance if Pro Extractor Blades Assembly is bent or damaged.
- 20 To reduce the risk of injury, never place the blade assembly on the base without the proper attachment.
- 21 **DO NOT** operate this appliance on or near any hot surfaces (such as gas or electric burner or in a heated oven).
- 22 The use of attachments or accessories including canning jars, not recommended by the manufacturer may result in fire, electric shock or personal injury.
- 23 **DO NOT** remove any container from the motor base while the appliance is in operation. Always unplug the unit when not in use.
- 24 To reduce the risk of injury, **NEVER** operate the appliance without the blade assembly in place; **DO NOT** try to defeat the interlock mechanism; make sure that the attachment is properly installed before operating the appliance.
- 25 **DO NOT** expose containers to extreme temperature changes.
- 26 **DO NOT** overfill. Do not exceed "MAX" fill line.
- 27 **DO NOT** operate the appliance empty.
- 28 If the appliance overheats, a thermal switch will become activated and shut off the motor. To reset, unplug the appliance and let it cool down for approximately 30 minutes before using again.
- 29 To reduce the risk of burns, always allow the appliance to cool before taking off parts and before cleaning.
- 30 Max ON time is 1 minute under 1000W load. If the appliance overheats, a thermal switch will become activated and shut off the motor. To reset, unplug the appliance and let it cool down for approximately 30 minutes before using again.
- 31 **THIS PRODUCT IS INTENDED FOR HOUSEHOLD USE ONLY.** Do not use this appliance for anything other than its intended use. Do not use outdoors.
- 32 Appliance accessories are not intended to be used in the microwave as it may result in damage to the accessories.
- 33 **DO NOT** remove lid until blade has **COMPLETELY STOPPED**.
- 34 **DO NOT** attempt operation without the cover being in place.

## SAVE THESE INSTRUCTIONS

Contents

Thank you for  
purchasing the  
Nutri Ninja®  
with Auto-iQ™

Getting to Know Your Nutri Ninja with Auto-iQ .....5  
Before First Use .....7  
Use of the Nutri Ninja Cups.....8  
Suggested Uses .....9  
Care & Maintenance .....10  
Troubleshooting Guide.....11  
Warranty & Registration.....14



**THIS BOOK COVERS MODEL NUMBERS:**  
BL480ANZMN 30

**TECHNICAL SPECIFICATIONS**  
Voltage: 220-240V~, 50/60Hz  
Power: 1000 Watts  
Nutri Ninja® Cup Capacity: 500ml  
650ml  
900ml

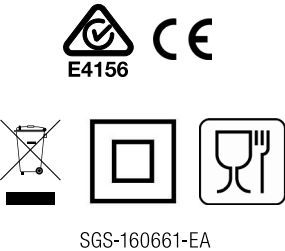

Getting To Know Your Nutri Ninja® with Auto-iQ™

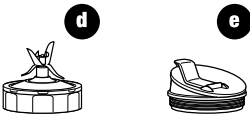
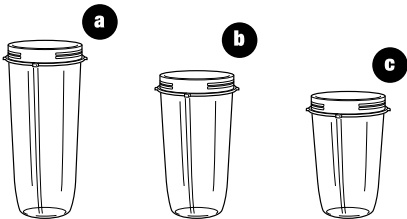

- a 900 ml Nutri Ninja Cup
- b 650 ml Nutri Ninja Cup
- c 500 ml Nutri Ninja Cup

- g Pro Extractor Blades™ Assembly
- h Sip & Seal™ Lid (x3)
- m Motor Base

Welcome to the Ninja® Auto-iQ™ Experience! The Nutri Ninja® with Auto-iQ features pre-programmed settings that take the guesswork out of drink and meal making. These programs are timed to deliver consistent, delicious results that finish on their own so all you have to do is press a button and enjoy!

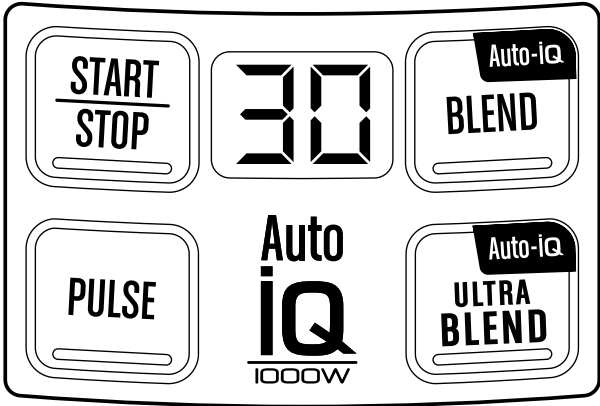

FEATURES:

- **Nutrient & Vitamin Extraction\***
- **1000 Watt Motor**
- **User Interface:**
  - START | STOP**  
Press once to start continuous running, press again to stop  
Timer counts up by seconds, up to 60 seconds
  - PULSE**  
Runs only while pressed down. Short presses make short pulses.  
Timer counts up by seconds as long as pressed down
  - AUTO-IQ BLEND**  
Pulses and blends fresh or softer ingredients to create smooth consistent results. Timer counts down.
  - AUTO-IQ ULTRA BLEND**  
Pulses and blends frozen, fibrous or hard ingredients to create smooth consistent results. Timer counts down.
- **Personalised, healthy drinks and juices**
- **Sip & Seal™ lids for drinks on the go**
- **Nutri Ninja Cups, BPA free**
- **Cord storage**

\*Extract a nutritious drink containing vitamins and nutrients from fruits and vegetables.



## Before First Use

### PLEASE KEEP THESE IMPORTANT SAFEGUARDS IN MIND WHEN USING THE APPLIANCE:

**IMPORTANT:** Make sure that the motor base is plugged in for use.

**IMPORTANT:** DO NOT attempt to operate the appliance without the lid on.

**IMPORTANT:** Never run the appliance empty.

**IMPORTANT:** Appliance accessories are not intended to be used in the microwave as it may result in damage to the accessories.

**CAUTION:** Do not immerse the motor base into water or any other liquid.

- 1 Remove all packaging material and labels from the appliance. Separate/remove all parts from each other.
- 2 Wash the lids, cups, and Pro Extractor Blades™ Assembly in warm, soapy water. When washing the Pro Extractor Blades Assembly, use a dish-washing utensil with a handle to avoid direct hand contact with blades.

**CAUTION:** Handle the Pro Extractor Blades Assembly with care when washing, as the blades are sharp.

- 3 Handle blade assemblies with care to avoid contact with sharp edges. Rinse and air dry thoroughly.
- 4 Cups, lids and Pro Extractor Blades Assembly are all dishwasher safe. It is recommended that the lids and Pro Extractor Blades Assembly be placed on the top rack. Ensure that the Pro Extractor Blades Assembly is removed from the containers or grinder before placing in the dishwasher.
- 5 Wipe the motor base clean with a damp cloth.

## Use of the Nutri Ninja® Cups

- WARNING:** Handle the Pro Extractor Blades™ Assembly with care, as the blades are sharp.
- WARNING:** Remove utensils prior to processing. Failure to remove may cause the Nutri Ninja Cup to be damaged or to shatter, which may cause personal injury.
- WARNING:** Never leave the appliance unattended while in use.
- CAUTION:** Do not blend hot liquids, doing so may cause excessive pressure buildup, resulting in risk of the user being burned.
- CAUTION:** Remove the Pro Extractor Blades Assembly from the Nutri Ninja Cup upon completion of blending. Do not store ingredients before or after blending them in the cup or jar with the blade assembly attached. Some foods may contain active ingredients or release gases that will expand if left in a sealed container, resulting in excessive pressure buildup that can pose a risk of injury. For ingredient storage in the cup, use Sip & Seal® Lid or spout lid to cover.
- IMPORTANT:** Make sure that the motor base is plugged in for use.
- IMPORTANT:** When processing soft dry ingredients such as day-old bread or cheese use quick, short 1 second pulses. Do not overfill to avoid overheating the appliance. Allow the appliance to cool after each use.

### ASSEMBLY

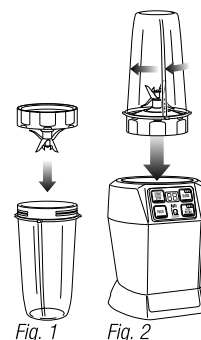

### USE



### REMOVAL

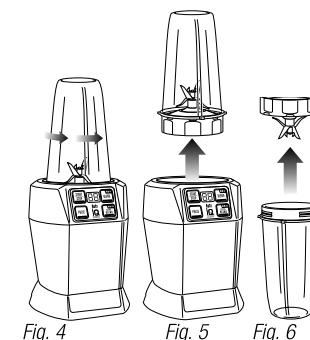

- 1 Review warning and caution statements above before proceeding to number 2.
- 2 Place the motor base on a clean, dry, level surface such as a counter or tabletop. Press down on the motor base to make sure that the suction cups adhere to the counter or tabletop.
- 3 Make sure that the motor base is plugged in for use. When the unit is plugged in and no cup installed, "--" is displayed on the timer.
- 4 Add ingredients to the cup.  
**NOTE:** Do not overfill! To avoid spilling, do not add ingredients past the "MAX" fill line.
- 5 Place the Pro Extractor Blades Assembly onto the cup and twist it on tightly until you have a good seal. (Fig. 1)
- 6 Turn the cup upside down and place it onto the motor base, aligning the tabs on the cup with the motor base. Turn it clockwise, until you feel it click into place. The Timer light will illuminate. (Fig. 2)
- 7 Press one of the buttons to activate. (Fig. 3)

**NOTE:** When using the Auto-iQ® presets, the unit will operate using pulses, pauses and continuous runs. The pauses allow the contents of the cup to settle. When the timer reaches "0", it will stop by itself.

- 8 To remove the cup, ensure that the motor has stopped running. Then turn the cup anticlockwise (Fig. 4) and pull straight up to remove. (Fig. 5)
- 9 Turn the cup upright and remove the Pro Extractor Blades Assembly by twisting the Pro Extractor Blades Assembly anticlockwise. (Fig. 6)
- 10 Do not store blended contents in the Nutri Ninja Cup with the Pro Extractor Blades Assembly attached.
- 11 Place the Sip & Seal Lid or spout lid onto the Nutri Ninja Cup, twist to seal and enjoy.
- 12 For storage, only use Sip and Seal Lid or spout lid to cover.
- 13 Be sure to store the Pro Extractor Blades Assembly attached to an empty cup when not in use.
- 14 Make sure that the motor base is unplugged when not in use.
- 15 To remove the motor base unit, tip the unit forward from the rear to easily disengage the suction cups.

## Suggested Uses

PURPOSE / FUNCTION	SUGGESTED CUP	TYPE OF FOOD
Chopping / Pulsing	500 ml Nutri Ninja Cup 650 ml Nutri Ninja Cup	Salsa Leafy Herbs Nuts Chocolate
Grating	500 ml Nutri Ninja Cup 650 ml Nutri Ninja Cup	Cheese Breadcrumbs
Mixing	650 ml Nutri Ninja Cup 900 ml Nutri Ninja Cup	Batters Dips
Sauces*	650 ml Nutri Ninja Cup 900 ml Nutri Ninja Cup	Vinaigrettes Salad Dressings Simple Sauces*
Frozen Blending	500 ml Nutri Ninja cup 650 ml Nutri Ninja cup 900 ml Nutri Ninja cup	Ice Frozen Fruit Ice Cream
Nutrient Juices/Smoothies	500 ml Nutri Ninja Cup 650 ml Nutri Ninja Cup 900 ml Nutri Ninja Cup	Fruits Vegetables Leafy Greens

**⚠ CAUTION: DO NOT process dry ingredients without adding liquid to the cup. This product is not intended for dry blending.**

\* When blending sauces, make sure they're cooled to room temperature first - Ninja® containers are not intended for hot blending.

### FILLING YOUR NUTRI NINJA®

Want to create smooth and delicious drinks using your Nutri Ninja cups? Simply add ingredients to the container in the order they appear in each recipe, or follow the guideline below when creating your own customised recipes. **(Fig. 1)**

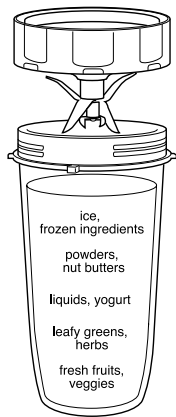

Fig. 1

## Care & Maintenance

### HOW TO CLEAN

**⚠ CAUTION: Make sure that the motor base is unplugged from the power source before inserting or removing any attachment and before cleaning.**

**⚠ CAUTION: DO NOT immerse the motor base into water or any other liquid.**

- 1 Separate/remove all parts from each other.
- 2 **Hand Washing:** Wash containers, lids, and Pro Extractor Blades Assembly in warm, soapy water. When washing the Pro Extractor Blades Assembly, use a dish-washing utensil with a handle to avoid direct hand contact with blades. Handle the Pro Extractor Blades Assembly with care to avoid contact with sharp edges. Rinse and air dry thoroughly.

**Dishwasher:** Containers, lids, and Pro Extractor Blades Assembly are all dishwasher safe. The lids and Pro Extractor Blades Assembly are top rack dishwasher safe. Ensure that the Pro Extractor Blades Assembly are removed from the containers before placing in the dishwasher.

**⚠ WARNING: Handle the Pro Extractor Blades Assembly with care when washing, as the blades are sharp. Contact with the blades' edges can result in laceration.**

- 3 Wipe the motor base clean with a damp cloth.

Please call customer service if any servicing needs to be performed on the appliance at AU: 1800 099 385 or \NZ: 0800 112 660.

### HOW TO STORE

- 1 Store the Nutri Ninja® with Auto-iQ® upright with the Pro Extractor Blades Assembly inside the corresponding container with the lid secured on top. Do not place anything on top. Store the rest of the attachments in a safe place where they will not be damaged and won't cause harm. Secure the power cord underneath the base by wrapping the cord around the cord wrap.

**NOTE: Do not store blended or unblended ingredients in the Nutri Ninja Cup with the blade assembly attached.**

### RESETTING THE MOTOR THERMOSTAT

The Nutri Ninja with Auto-iQ features a unique safety system which prevents damage to the unit's motor and drive system should you inadvertently overload your appliance. If the appliance is being overloaded, the motor will stop. To reset the appliance, follow the resetting procedure below:

- 1 Unplug the appliance from the electrical outlet.
- 2 Remove and empty the cup and ensure that no food is jamming the Pro Extractor Blades Assembly.
- 3 Allow the appliance to cool for approximately 30 minutes.
- 4 Re-install the cup onto the base and re-plug the appliance into the electrical outlet.
- 5 Proceed to use the appliance as before while making sure not to exceed the recommended maximum capacities.



## Troubleshooting Guide

PROBLEMS	POSSIBLE REASONS & SOLUTIONS
<b>Unit doesn't turn on</b>	<ul style="list-style-type: none"> <li>Make sure the unit is plugged in. When the unit is plugged in and no jar installed, "--" is displayed on the timer.</li> <li>Insert and rotate cup clockwise in the base until it "clicks". The timer light will illuminate.</li> </ul>
<b>Unit doesn't turn off</b>	<ul style="list-style-type: none"> <li>Remove cup from base by rotating cup anticlockwise and lifting out. Display should turn off. Unplug the power cord from the outlet.</li> </ul>
<b>Lid/blade assembly hard to assemble</b>	<ul style="list-style-type: none"> <li>Set the cup on a level surface. Place the lid or blade assembly on the top of the cup and align the threads so that the lid/blades sit flat on the cup. Twist clockwise so that the lid/blades evenly align to the cup until you have a tight seal.</li> </ul>
<b>Food is not evenly chopped</b>	<ul style="list-style-type: none"> <li>For best results when chopping, make sure all ingredients are as dry as possible. Cut pieces down to even sizes, and reduce the amount of food in the cup. Use very short pulses by quickly pressing the "PULSE" button.</li> </ul>
<b>Doesn't mix well, food gets stuck.</b>	<ul style="list-style-type: none"> <li>Using the Auto-iQ™ programs is the easiest way to achieve great results. The pulses and pauses allow the food to settle towards the blade. If food is routinely getting stuck adding some liquid will usually help.</li> <li>When packing the cups, start with fresh items, then powders/nuts. Add liquids, and finally frozen items or ice.</li> </ul>
<b>Motor base won't stick to counter or tabletop</b>	<ul style="list-style-type: none"> <li>Make sure surface and suction feet are wiped clean. Suction feet will only stick to smooth surfaces. Suction feet WILL NOT stick on some surfaces such as, wood, tile and non-polished finishes.</li> <li>DO NOT attempt to use appliance when the motor base is stuck to a surface that is not secure, (cutting board, platter, plates, etc.).</li> </ul>
<b>Unit is difficult to remove from counter for storage</b>	<ul style="list-style-type: none"> <li>Tip unit forward from the back to easily disengage the suction feet.</li> </ul>

## Notes

[illegible]

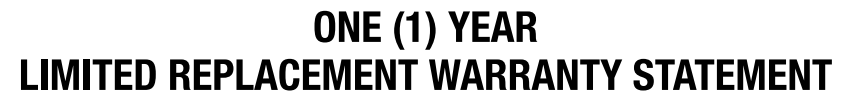
[illegible]

- **For New Zealand Consumers:** We will replace the product with a new product, free of charge, or repair the product at our cost, at our discretion.
- **For Australian Consumers:** Our goods come with guarantees that cannot be excluded under the Australian Consumer Law. You are entitled to a replacement or refund for a major failure and for compensation for any other reasonably foreseeable loss or damage. You are also entitled to have the goods repaired or replaced if the goods fail to be of acceptable quality and the failure does not amount to a major failure.

- **DO NOT** operate the appliance with a damaged plug or cord, or if the unit has been dropped, damaged or dropped in water. To avoid the risk of electric shock, do not disassemble or attempt to repair the appliance on your own. If the supply cord is damaged, **it must be replaced by a qualified electrician in order to avoid a hazard.** Incorrect re-assembly or repair can cause a risk of electrical shock or injury to persons when the appliance is used.
- The product has not been misused, abused, neglected, altered, modified or repaired by anyone.
- The product has been subjected to fair wear and tear.
- The product has not been used for trade, professional or hire purposes.
- The product has not sustained damage through foreign objects, substances or accident.

- Components that are subject to natural wear and tear caused by normal use in accordance with operating instructions.
- Unauthorised/improper maintenance/handling or overload is excluded from this warranty.
- For guarantee claims you will need to submit a proof of purchase in the form of a valid receipt that displays date and place of purchase.

Replacement products will be covered by the limited warranty for the balance of the warranty period from the date of the original purchase.

Only defective product or parts returned to place of purchase will be replaced under this warranty.

**www.ninjakitchen.com.au**



# Mann&Noble

## Proudly distributed by

Mann&Noble Pty Ltd  
No.1 Southridge Unit Estate  
2 Southridge Street  
Eastern Creek NSW  
Australia, 2766

AU: 1800 099 385

NZ: 0800 112 660

[www.ninjakitchen.com.au](http://www.ninjakitchen.com.au)

Copyright © SharkNinja Operating LLC 2017

Printed in China

**Auto-iQ**, **Ninja** and **Nutri Ninja** are registered trademarks of SharkNinja Operating LLC.

**Pro Extractor Blades** and **Sip & Seal** are trademarks of SharkNinja Operating LLC.

Illustrations may differ from actual product. We are constantly striving to improve our products, therefore the specifications contained herein are subject to change without notice.

BL480ANZMN\_IB\_180105



SGS-160661-EA